

MOUNTING DIMENSIONS (for reference only)

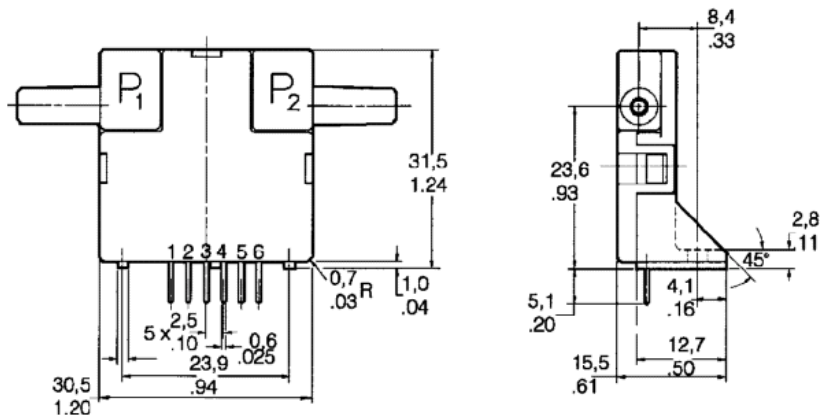
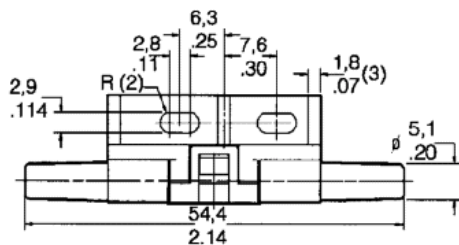

NOTE: Positive flow direction is defined as proceeding from Port 1 (P₁) to Port 2 (P₂) and results in positive output (Pin 6 > Pin 2). Negative flow direction is defined conversely and results in negative output (Pin 6 < Pin 2). Do not exert a force greater than 4.54 kg (10 lbs.) in any direction.