

## 802PR 2-wire AC, High-output Rectangular Sensors

### Limit Switch Style



802PR AC Conduit Style



802PR AC Cable Style



802PR AC Mini QD Style

#### Specifications

Attribute	802PR
Load Current	≤1 A at 40 °C (104 °F) linearly de-rated to 0.5 A at 75 °C (167 °F)
Inrush Current	≤10 A/1 s
Current Consumption	25 mA, min.
Leakage Current	≤3.5 mA (60...132V AC); ≤6.5 mA (102...132V AC)
Operating Voltage	60...132V AC or 102...132V AC
Voltage Drop	≤8.5V
Repeatability	≤0.025 mm
Hysteresis	15% (max.)
Protection Type	False pulse, transient noise
Certifications	UL Listed, CSA Certified, and CE Marked for all applicable directives
Enclosure Type Rating	NEMA 1, 2, 3, 4, 4X, 12, 13, IP65 (IEC529)
Housing Material	Self-extinguishing glass reinforced polyester body
Connection Type	<ul style="list-style-type: none"> <li>Cable: 2.4 m (8 ft) or 3.7 m (12 ft) length, 2-conductor 16 AWG STO (oil-resistant thermoplastic)</li> <li>Quick-disconnect: 3-pin mini; Conduit Opening or Conduit Coupler: 1/2-14 NPT internal thread with screw terminals (use #18...14 AWG wire)</li> </ul>
Status Indicator	Red: Output energized
Operating Temperature	-25...+75 °C (-13...+167 °F)
Shock	30 g (1.06 oz), 11 ms
Vibration	55 Hz, 1 mm amplitude, 3 planes

#### Correction Factors

Target Material	Correction Factors
Steel	1.0
Stainless Steel	0.8...0.85
Brass	0.5...0.55
Aluminum	0.45...0.5
Copper	0.4...0.45

**Approximate Dimensions [mm (in.)]**

**Cable Style**

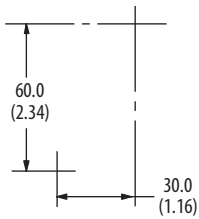
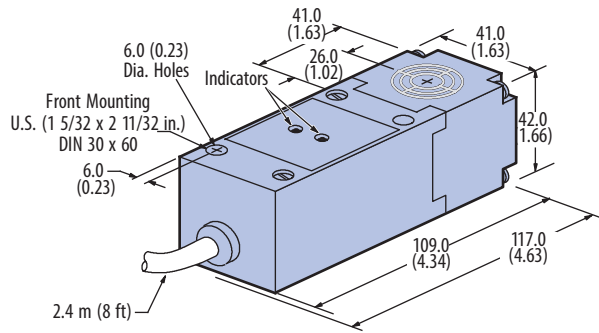

Front Mounting Hole Pattern Front View  
Two Holes for #10 or M5 Screws

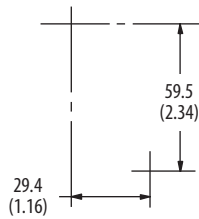

Rear Mounting Hole Pattern Front View  
Two #10-32 Tapped Holes 9.5 (0.38)  
Deep (LB Version Only)

**Wiring Diagrams**

**Normally Open**

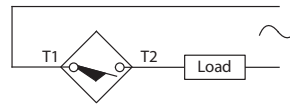

**Wiring Diagrams**

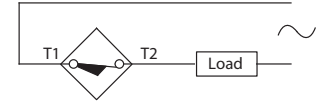

**Note:** Load can be switched to white lead.

**Mini QD Style**

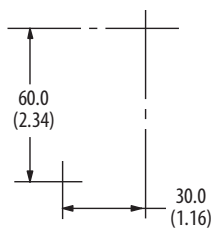
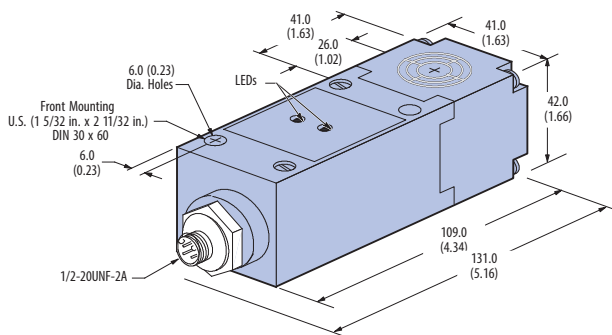

Front Mounting Hole Pattern Front View  
Two Holes for #10 or M5 Screws

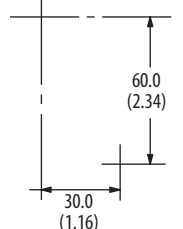

Rear Mounting Hole Pattern Front View  
Two #10-32 Tapped Holes 9.5 (0.38)  
Deep (LB Version Only)

**Normally Open or Normally Closed**

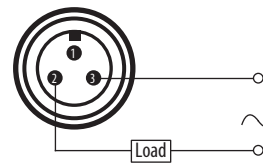

**Note:** Load can be switched to pin 3.

**Note 1:** Side sensing model heads can be turned in 90° increments to accommodate four side-sensing positions.

**Note 2:** Low voltage models have two status indicators.

**Approximate Dimensions [mm (in.)]**

**Cable Style**

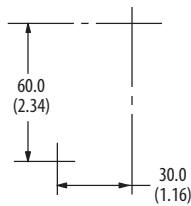
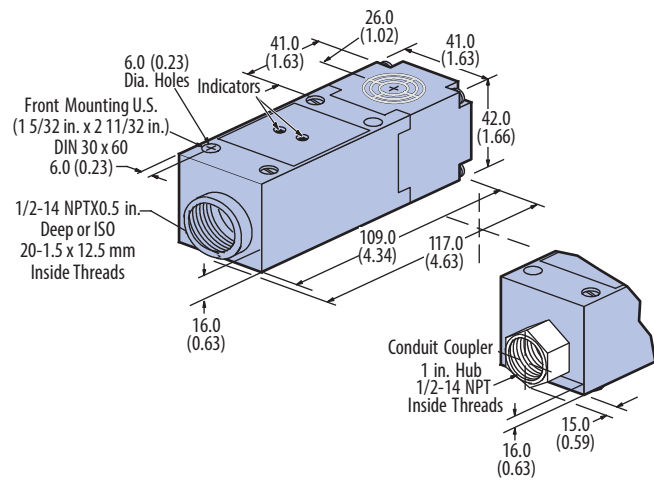

Front Mounting Hole Pattern Front View  
Two Holes for #10 or M5 Screws

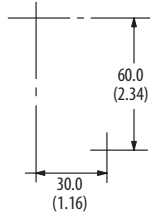

Rear Mounting Hole Pattern Front View  
Two #10-32 Tapped Holes 9.5 (0.38)  
Deep (LB Version Only)

**Wiring Diagrams**

**Normally Open**

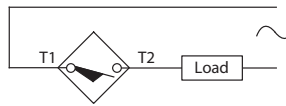

**Normally Closed**

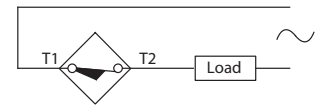

**Note:** Load can be switched to terminal 1

**Note 1:** Side sensing model heads can be turned in 90° increments to accommodate four side-sensing positions.

**Note 2:** Low voltage models have two status indicators.

## 802PR 2-wire AC Hazardous Location, High-output Rectangular Sensors

### Limit Switch Style



802PR AC Conduit Style

#### Specifications

Attribute	802PR
Load Current	≤1 A at 40 °C (104 °F) linearly derated to 0.5 A at 75 °C (167 °F)
Inrush Current	≤10 A/1 s
Current Consumption	25 mA, min.
Leakage Current	≤6.5 mA
Operating Voltage	102...132V AC
Voltage Drop	≤8.5V
Repeatability	≤0.025 mm
Hysteresis	15% (max.)
Protection Type	False pulse, transient noise
Certifications	UL Listed and CSA Certified
Enclosure Type Rating	NEMA 1, 2, 3, 4, 12, 13; IP65 (IEC529) Division 2 Class I: Groups A, B, C, and D; Class II: Groups F and G; Class III: All groups
Housing Material	Self-extinguishing glass reinforced polyester body
Connection Type	Conduit Coupler: 1/2 -14NPT internal thread with screw terminals (use #18...14 AWG wire)
Status Indicator	Red: Output energized
Operating Temperature	-25...+75 °C (-13...+167 °F)
Shock	30 g (1.06 oz), 11 ms
Vibration	55 Hz, 1 mm amplitude, 3 planes

#### Correction Factors

Target Material	Correction Factors
Steel	1.0
Stainless Steel	0.8...0.85
Brass	0.5...0.55
Aluminum	0.45...0.5
Copper	0.4...0.45

#### Approximate Dimensions [mm (in.)]

##### Conduit Style

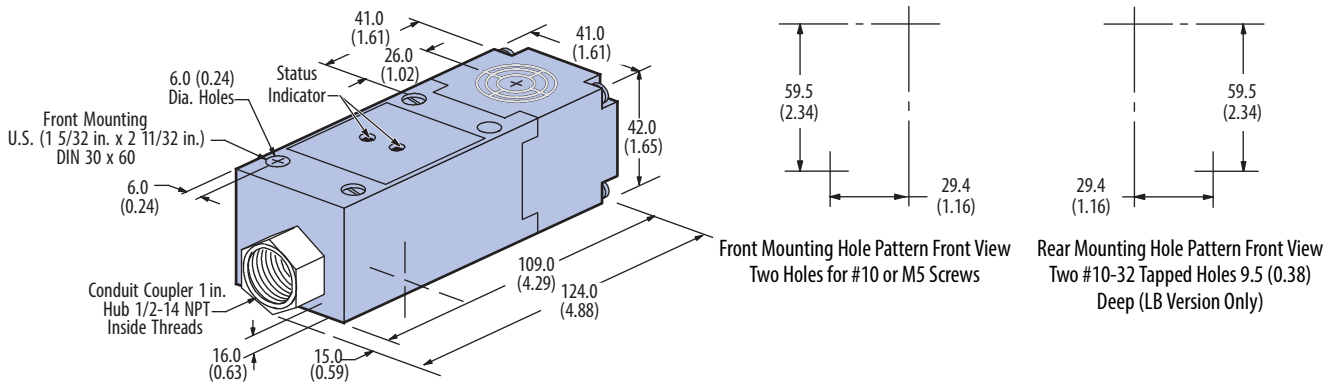

**Note:** Side sensing model heads can be turned in 90° increments to accommodate four side-sensing positions.

## 2-wire AC/DC Rectangular Sensors

### Limit Switch Style



802PR AC/DC Cable Style



802PR AC/DC Mini Quick-disconnect Style



802 AC/DCM Quick-disconnect Style



802PR AC/DC Conduit Style

#### Specifications

Attribute	802
Load Current	AC 4...25 mA; DC 2...25 mA
Leakage Current	≤1.7 mA at 132V, ≤2.5 mA at 250V
Operating Voltage	20...250V AC/DC
Voltage Drop	≤10V
Repeatability	≤10% typical
Hysteresis	≤10% typical
Protection Type	Transient noise, short circuit, overload, false pulse, radio frequency (10V per meter; frequency range 20...1000 MHz)
Certifications	UL Listed, CSA Certified, and CE Marked for all applicable directives
Enclosure Type Rating	NEMA 1, 2, 3, 4, 4X, 12, 13, IP65 (IEC529)
Housing Material	Self-extinguishing glass-reinforced polyester body
Connection Type	<ul style="list-style-type: none"> <li>Cable: 2.4 m (8 ft) length, 2-conductor ToughLink</li> <li>Quick-disconnect: 3-pin micro style, 3-pin mini style</li> <li>Conduit Opening or Conduit Coupler: Internal thread with screw terminals (use #18...14 AWG wire)</li> </ul>
Status Indicator	<ul style="list-style-type: none"> <li>Green: Power</li> <li>Red: Output energized (both on in SCP/overload)</li> </ul>
Operating Temperature	-25...+75 °C (-13...+167 °F)
Shock	30 g (1.06 oz), 11 ms
Vibration	55 Hz, 1 mm amplitude, 3 planes

#### Correction Factors

Target Material	Correction Factors
Steel	1.0
Stainless Steel	0.9
Brass	0.8
Aluminum	0.75
Copper	0.7

**Approximate Dimensions [mm (in.)]**

**Cable Style**

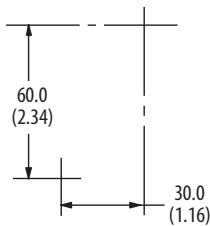
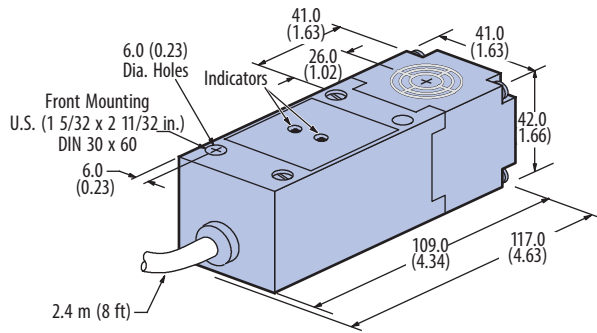

Front Mounting Hole Pattern Front View  
Two Holes for #10 or M5 Screws

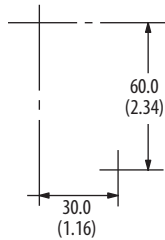

Rear Mounting Hole Pattern Front View  
Two #10-32 Tapped Holes 9.5 (0.38) Deep (LB Version Only)

**Wiring Diagrams**

**Normally Open**

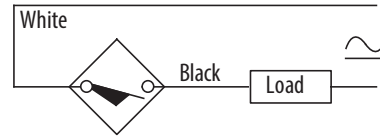

**Note:** Load can be switched to white lead.

**Mini QD Style**

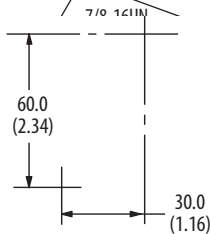
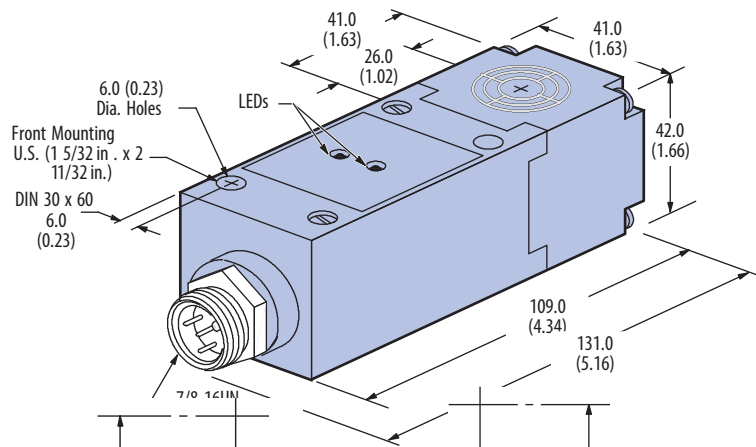

Front Mounting Hole Pattern Front View  
Two Holes for #10 or M5 Screws

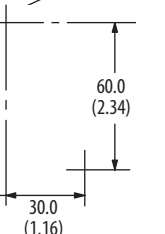

Rear Mounting Hole Pattern Front View  
Two #10-32 Tapped Holes 9.5 (0.38) Deep (LB Version Only)

**Normally Open**

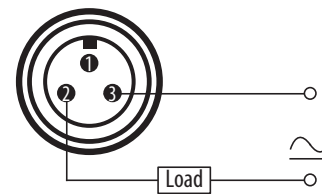

**Note:** Load can be switched to pin 3.

Approximate Dimensions [mm (in.)]

Micro Style

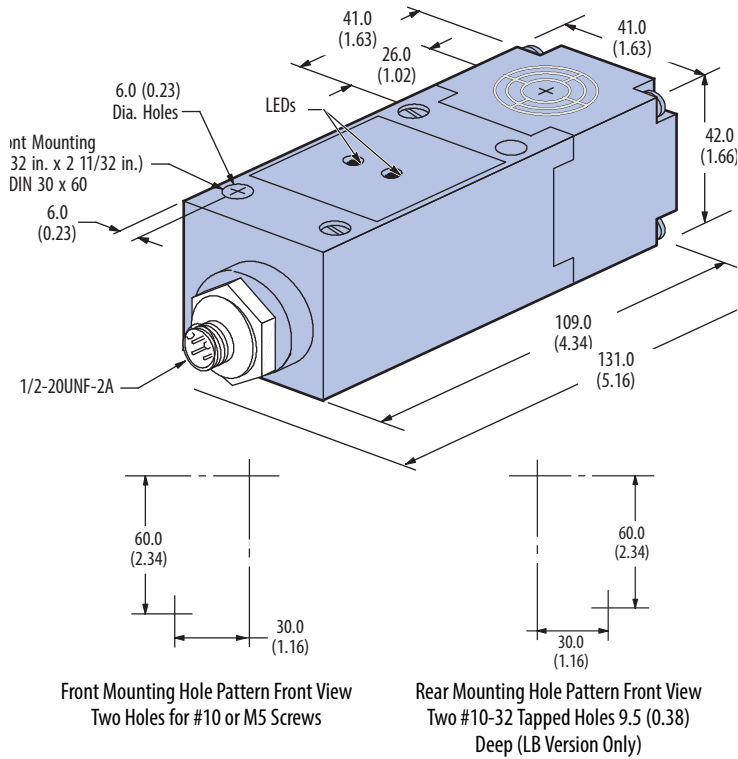

Wiring Diagrams

Normally Open

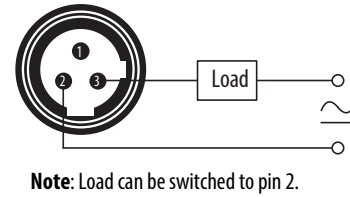

Conduit QD Style

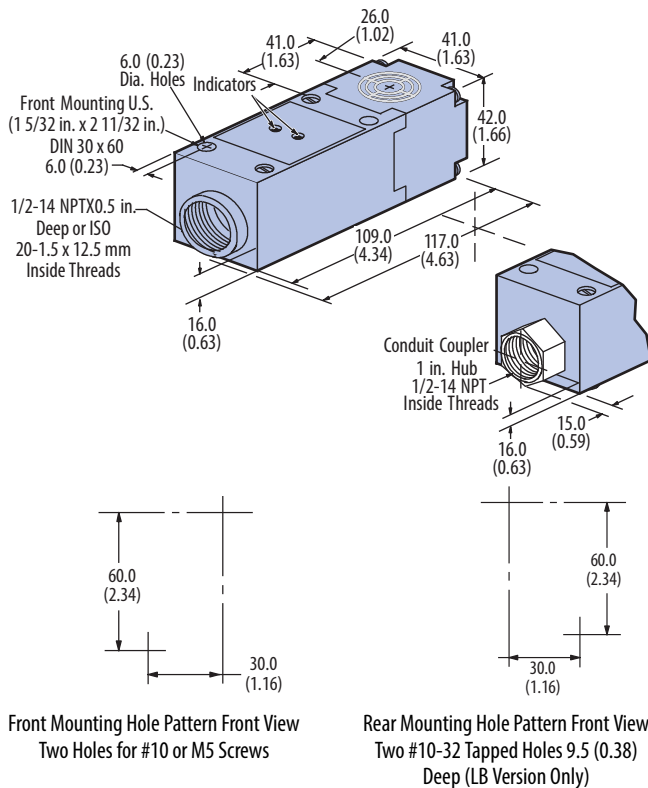

Normally Open

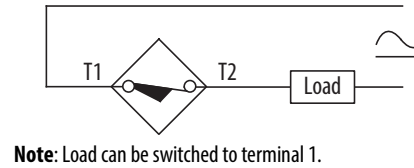

Note: Side sensing model heads can be turned in 90° increments to accommodate four side-sensing positions.

## 802PR 2-wire AC/DC Hazardous Location Rectangular Sensors

### Limit Switch Style



802PR AC Conduit Style

#### Specifications

Attribute	802PR
Load Current	AC: 4...25 mA, DC: 2...25 mA
Leakage Current	≤1.7 mA at 132V, ≤2.5 mA at 250V
Operating Voltage	20...250V AC/DC
Voltage Drop	≤10V
Repeatability	≤10% typical
Hysteresis	≤10% typical
Protection Type	Transient noise, short circuit, overload, false pulse, radio frequency (≤10V per meter; frequency range 20...1000 MHz)
Certifications	UL Listed and CSA Certified
Enclosure Type Rating	NEMA 1, 2, 3, 4, 12, 13; IP65 (IECS29); Division 2 Class I: Groups A, B, C, and D; Class II: Groups F and G; Class III: All groups
Housing Material	Self-extinguishing glass-reinforced polyester body
Connection Type	Conduit Coupler: 1/2 - 14 NPT internal thread with screw terminals, use #18...14 AWG wire
Status Indicator	<ul style="list-style-type: none"> <li>Green: Power</li> <li>Red: Output energized (both on in SCP/Overload)</li> </ul>
Operating Temperature	-25...+75 °C (-13...+167 °F)
Shock	30 g (1.06 oz), 11 ms
Vibration	55 Hz, 1 mm amplitude, 3 planes

#### Correction Factors

Target Material	Correction Factors
Steel	1.0
Stainless Steel	0.9
Brass	0.8
Aluminum	0.75
Copper	0.7

**Approximate Dimensions [mm (in.)]**

**Conduit Style**

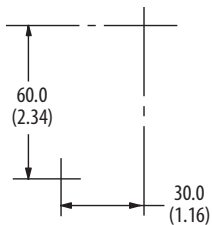
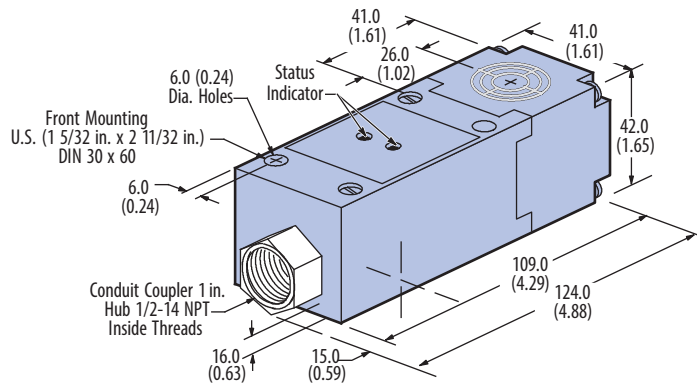

Front Mounting Hole Pattern Front View  
Two Holes for #10 or M5 Screws

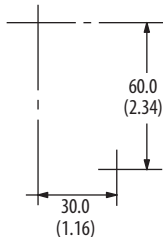

Rear Mounting Hole Pattern Front View  
Two #10-32 Tapped Holes 9.5 (0.38) Deep (LB Version Only)

**Wiring Diagrams**

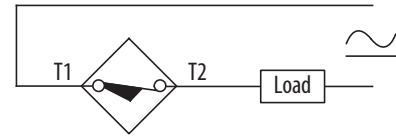

**Note:** Load can be switched to terminal 1.

**Note:** Side sensing model heads can be turned in 90° increments to accommodate four side-sensing positions.