

Bul. 800MR - Momentary Contact Push Buttons

Momentary Contact Push Button Units, Non-Illuminated



Flush Head Unit
Cat. No. 800MR-A1B



Extended Head Unit
Cat. No. 800MR-B2A



Mushroom Head Unit
Cat. No. 800MR-D2B

800MR – $\frac{A}{a}$ $\frac{1}{b}$ $\frac{A}{c}$ $\frac{\quad}{d}$

a

Operator Type★	
Code	Description
A	Flush head
B	Extended head
D	Mushroom head

b

Button Color	
Code	Description
1	Green
2	Black
3	Orange
4	Grey
5	White
6	Red
7	Blue
9	Yellow

c

Standard Contact Cartridges	
Code	Description
Blank	No contacts
A	1 N.O. - 1 N.C.
A2	2 N.O.
A3	1 N.O.E.M. - 1 N.C.L.B.
A4	2 N.C.
A7	1 N.C.L.B. - 1 N.C.
B	2 N.O. - 2 N.C.
D1	1 N.O.
D2	1 N.C.

d

Contact Block Termination Type‡	
Code	Description
Blank	Stab terminals
K	Large screw

- ★ Guards must be ordered separately.
- ‡ Logic Reed and small screw blocks can be ordered separately.

Momentary Contact Push Button Units, Illuminated



Flush Head Unit
Cat. No. 800MR-QA24GA



Extended Head Unit
Cat. No. 800MR-PB16RA



Mushroom Head Unit
Cat. No. 800MR-QMB24RA

800MR – PA L 24 R
a b c d e f

a

Operator	
Transformer	
Code	Description
PA	Flush ♦
PB	Extended
PMB	Mushroom
Full Voltage	
Code	Description
QA	Flush ♦
QB	Extended
QMB	Mushroom

c

Input Voltage	
Full Voltage	
Code	Description
12	12V AC/DC
24	24V AC/DC
10	120V AC ♣
Transformer	
Code	Description
16	120V AC 50/60 Hz
26	240V AC 50/60 Hz

e

Standard Contact Cartridges	
Code	Description
Blank	No contacts
A	1 N.O. - 1 N.C.
A2	2 N.O.
A3	1 N.O.E.M. - 1 N.C.L.B.
A4	2 N.C.
A7	1 N.C.L.B. - 1 N.C.
B	2 N.O. - 2 N.C. Δ
D1	1 N.O.
D2	1 N.C.

b

Illumination Options	
Code	Description
Blank	Standard illumination as determined by power module type
L	LED §

d

Lens Color	
Code	Color
A	Amber
B	Blue
C	Clear
G	Green
R	Red
W	White
X	No lens with contact blocks
Blank	No lens without contact blocks

f

Contact Block Termination Type ♣	
Code	Description
Blank	Stab terminals
K	Large screw

§ LEDs available in red, green, amber, blue, and white. LED color must match lens color, except clear lens supplied with white LED and white lens supplied with amber LED.

♣ Only available with LED illumination option.

Δ Only available with full voltage power module option and standard stab terminations.

♦ Guards must be ordered separately.

♠ Logic Reed and small screw blocks must be ordered separately.

Bul. 800MR - Push-Pull

2-Position Push-Pull and Push-Pull/Twist Release and 3-Position Push-Pull Units, Non-Illuminated



2-Position Push-Pull
Cat. No. 800MR-FX6A



2-Position Push-Pull/Twist
Cat. No. 800MR-FXT6A4

800MR – FX T 6 A (2-Position)
 a b c d e f

800MR – FX N 6 A (3-Position)
 a b₁ c d e f

a

Operator Type	
Code	Description
FX	Push-pull unit

b

Operator Function	
2-Position	
Code	Description
Blank	Maintained — push-pull
T	Twist-release

b₁

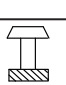
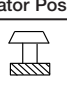
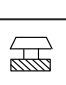
Operator Function			
3-Position★			
Code	Operator Position		
			
	Out	Center	In
N	Momentary	Maintained	Momentary

c

Operator	
Code	Color
Blank	Non-illuminated

d

Button Color	
Code	Color
1	Green
2	Black
3	Orange
4	Grey
5	White
6	Red
7	Blue
9	Yellow
Blank	No cap

e

Contact Cartridges	
Code	Description
Blank	No contacts
A	1 N.O. - 1 N.C.
A2	2 N.O.
A4	2 N.C.
A7	1 N.C.L.B. - 1 N.C.
B	2 N.O. - 2 N.C.
D1	1 N.O.
D2	1 N.C.

Note: See Table 1 for Target description.

f

Contact Block Termination Type†	
Code	Description
Blank	Stab terminals
K	Large screw

Table 1. Target Selection

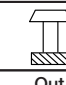
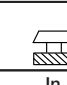
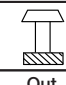
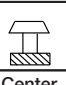
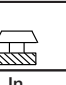
Code	2-Position		Contact Description	3-Position			Code
							
	Out	In		Out	Center	In	
Blank	—	—	No contacts	—	—	—	Blank
D1	O	X	N.O.	—	—	—	—
D2	X	O	N.C.	—	—	—	—
A	O X	X O	N.O. - N.C.	O X	O O	X O	A
A2	O O	X X	N.O. - N.O.	O O	O O	X X	A2
A4	X X	O O	N.C. - N.C.	X X	O O	O O	A4
—	—	—	N.C. - N.C.L.B.	X X	O X	O O	A7
B	O X O X	X O X O	N.O. - N.C. N.O. - N.C.	O X O X	O O O O	X O X O	B

Note: X = Closed/O = Open

★ Not available in twist release.

† Logic Reed and small screw blocks must be ordered separately.

2-Position Push-Pull and Push-Pull/Twist Release and 3-Position Push-Pull Units, Illuminated



Illuminated 2-Position Push-Pull
Cat. No. 800MR-FXQ24RA



Illuminated 2-Position Push-Pull/Twist
Cat. No. 800MR-FXTP16RA

800MR – FX T P 16 R A (2-Position)

a *b* *c* *d* *e* *f* *g* *h*

800MR – FX N P 16 R A (3-Position)

a *b₁* *c* *d* *e* *f* *g* *h*

a

Operator Type	
Code	Description
FX	Push-pull unit

b

Operator Function	
2-Position	
Code	Description
Blank	Maintained
T	Twist-release

b₁

Operator Function			
3-Position			
Code	Operator Position		
N	Momentary	Maintained	Momentary

c

Operator Type	
Code	Description
P	Transformer
Q	Full voltage

d

Illumination Options	
Code	Description
Blank	Incandescent lamp
L	LED‡

e

Voltage	
Full Voltage	
Code	Description
12	12V AC/DC
24	24V AC/DC
10	120V AC§
Transformer	
Code	Description
16	120V AC 50/60 Hz
26	240V AC 50/60 Hz

f

Button Color	
Code	Color
A	Amber
B	Blue
C	Clear
G	Green
R	Red
W	White★
X	No cap

g

Contact Cartridges	
Code	Description
Blank	No contacts
A	1 N.O. - 1 N.C.
A2	2 N.O.
A4	2 N.C.
A7	1.N.C.L.B. - 1 N.C.
B	2 N.O. - 2 N.C.♣
D1	1 N.O.
D2	1 N.C.

Note: See Table 1 for Target description.

Table 2. Target Selection

Code	2-Position		Contact Description	3-Position			Code
	Out	In		Out	Center	In	
Blank	—	—	No contacts	—	—	—	Blank
D1	O	X	N.O.	—	—	—	—
D2	X	O	N.C.	—	—	—	—
A	O X	X O	N.O. - N.C.	O X	O O	X O	A
A2	O O	X X	N.O. - N.O.	O O	O O	X X	A2
A4	X X	O O	N.C. - N.C.	X X	O O	O O	A4
—	—	—	N.C. - N.C.L.B.	X X	O X	O O	A7
B	O X O X	X O X O	N.O. - N.C. N.O. - N.C.	O X O X	O O O O	X O X O	B

h

Contact Block Termination Type△	
Code	Description
Blank	Stab terminals
K	Large screw

Note: X = Closed/O = Open

★ Not available in twist release.

‡ LEDs available in red, green, amber, blue, and white. LED color must match lens color, except clear lens supplied with white LED and white lens supplied with amber LED.

§ Only available with LED Illumination option.

♣ Only available with full voltage power module option and standard stab terminations.

△ Logic Reed and small screw blocks must be ordered separately.

Bul. 800MR - Selector Switches
2-Position Selector Switch Units, Non-Illuminated



Standard Knob Operator
Cat. No. 800MR-HH2BLA



Knob Lever Operator
Cat. No. 800MR-HK2BLA

800MR – H H 2 B L A _____
 a b c d e e₁ f

(Selector Switch)

800MR – H _____ 31 _____ B L A _____
 a b c₁ c₂ d e e₁ f

(Cylinder Lock)

a

Operator Positions	
Code	Description
H	2-position selector switch
H	2-position cylinder lock

b

Operator Color and Type§	
Standard Knob	
Code	Description
X	No knob
H	Black
Knob Lever	
Code	Description
X	No knob lever
K	Black
Cylinder Lock	
Code	Description
Blank	Key

c

Operator Function	
Standard Knob	
Code	Description
2	Maintained
4	Spring return from left
5	Spring return from right

c₁

Operator Function/Locking Position★	
Maintained	
Code	Description
31	Lock in left
32	Lock in right
33	Lock in both
Spring Return From Left	
Code	Description
42	Lock in right
Spring Return From Right	
Code	Description
48	Lock in left

c₂

Key Codes‡		
Code	Key No.	Master Key
Blank	T100 (standard)	1T
02	T101	1T
03	T102	1T
04	T106	1T
05	T107	1T
07	T109	2T
08	T134	2T
09	T135	2T
10	T136	2T
14	T147	2T

d

Cam Type	
Code	Description
B	B cam

e

Contact Cartridge Position	
Code	Description
Blank	Both left and right
L	Left

e₁

Contact Cartridges		
Code	Description	
Blank	No contacts	
Δ A	1 N.O. - 1 N.C.	
Δ A2	2 N.O.	
Δ A4	2 N.C.	
♦ B	2 N.O. - 2 N.C.	
Δ D1	1 N.O.	
Δ D2	1 N.C.	
♦ P1	3 N.O.	
♦ P2	3 N.C.	
♦ P3	2 N.O. - 1 N.C.	
♦ P4	2 N.C. - 1 N.O.	
♦ P5	4 N.O.	
♦ P6	4 N.C.	
♦ P7	3 N.O. - 1 N.C.	
♦ P8	1 N.O. - 3 N.C.	

Note: See Table 1 for Target arrangements

f

Contact Block Termination Type♣	
Code	Description
Blank	Stab terminals
K	Large screw

Table 1. Selector Switch Cam Targets

Cam Description (2-Position)			
Target		Operator Function	
		Maintained and Spring Returned From Right	Spring Returned From Left
X	O	N.C.	N.O.
O	X	N.O.	N.C.

Note: X = Closed/O = Open

★ Key removable in locked position only.

‡ If no optional key code is specified, the standard key (T100) will be supplied.

§ Red, green, blue, yellow, orange, grey, and white non-illuminated selector switch knobs and lever knobs must be ordered separately.

♣ Logic Reed and small screw contact blocks must be ordered separately.

Δ Contact cartridge position code (Table e) must be L.

♦ Contact cartridge position code (Table e) must be --.

4-Position Selector Switch Units, Non-Illuminated



Standard Knob Operator
Cat. No. 800MR-NH2QB



Knob Lever Operator
Cat. No. 800MR-NK2QB

800MR – N H 2 Q B _____ (Selector Switch)
 a b c d e f

800MR N _____ 31 _____ Q B _____ (Cylinder Lock)
 a b c₁ c₂ d e f

a

Operator Positions	
Code	Description
N	4-position selector
N	4-position cylinder lock

b

Operator Color and Type*		
Standard Knob	Description	Knob Lever
Code		Code
X	No knob	X
H	Black	K
Blank	Key	Blank

c

Operator Function‡	
Code	Description
2	Maintained

c₁

Operator Function/Locking Position*	
Standard Key	
Code	Description
31	Lock in position 1
32	Lock in position 2
33	Lock in position 3
34	Lock in position 4
41	Lock in position 1-2
42	Lock in position 1-3
43	Lock in position 1-4
44	Lock in position 2-3
45	Lock in position 2-4
46	Lock in position 3-4
51	Lock in position 1-2-3
52	Lock in position 1-2-4
53	Lock in position 1-3-4
54	Lock in position 2-3-4
61	Lock in all positions

c₂

Key Codes§		
Code	Key No.	Master Key
Blank	T100 (standard)	1T
02	T101	1T
03	T102	1T
04	T106	1T
05	T107	1T
07	T109	2T
08	T134	2T
09	T135	2T
10	T136	2T
14	T147	2T

d

Cam Type and Target Table					
Q					
Target				Contact Type (Rear View)	
				Left	Right
				1 N.O.	—
O	O	O	X	1 N.C.	—
O	O	X	O	—	1 N.O.
O	X	O	O	—	1 N.C.
X	O	O	O	—	1 N.C.

Note: X = Closed/O = Open

e

Contact Cartridges	
Standard Block/Stab Terminations	
Code	Description
Blank	No contacts
B	2 N.O. - 2 N.C.

f

Contact Block Termination TypeΔ	
Code	Description
Blank	Stab terminals
K	Large screw

- * Red, green, blue, yellow, orange, grey, and white non-illuminated selector switch knobs and knob levers must be ordered separately.
- * Key removable in locked position only.
- ‡ Operators are maintained in all positions.
- § If no optional key code is specified, the standard key (T100) will be supplied.
- Δ Logic Reed and small screw contact blocks must be ordered separately.

Bul. 800MB
Momentary Contact Push Button Units, Non-Illuminated



Flush Head Unit
 Cat. No. 800MB-CA1B



Extended Head Unit
 Cat. No. 800MB-CB1B

800 MB - CA 1 A _____
 a b c d e

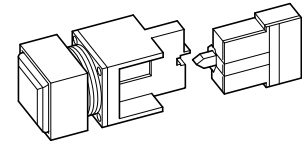

a

Bezel Color†	
Code	Color
MB	Black

b

Operator Type	
Code	Description
CA	Flush head
CB	Extended head

c

Color Insert	
Code	Color
X	No color insert
1	Green
3	Orange
4	Grey
5	White
6	Red★
7	Blue
9	Yellow

d

Contact Block(s)	
Standard	
Code	Description
Blank	No contacts
D1	1 N.O.
D2	1 N.C.
A	1 N.O. - 1 N.C.
A2	2 N.O.
A4	2 N.C.
A7	1 N.C.L.B. - 1 N.C.
B	2 N.O. - 2 N.C.

e

Contact Block Termination Type§	
Code	Description
Blank	Stab terminals
K	Large screw

★ Red flush head must be ordered separately.
 † Grey bezel can be ordered separately.
 § Logic Reed and small screw contact blocks must be ordered separately.

Momentary Contact Push Button Units, Illuminated

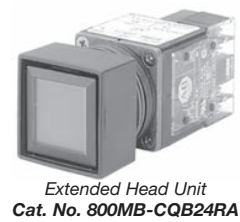

800 MB - CQ A L 06 R A h

a b c d e f g h

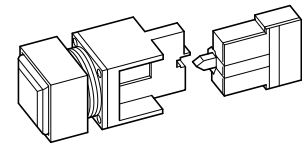

a

Bezel Color†	
Code	Color
MB	Black

b

Power Module Type	
Code	Description
CQ	Full voltage
CP	Transformer

c

Operator Type	
Code	Description
A	Flush
B	Extended

d

Illumination Options	
Code	Description
Blank	Incandescent
L	LED§♣

e

Voltage	
Full Voltage	
Code	Description
12	12V AC/DC
24	24V AC/DC
10	120V ACΔ
Transformer	
Code	Description
16	120V AC
26	240V AC

f

Color Insert	
Code	Color
Blank	No contacts
X	Packet of colored inserts♦
A	Amber
B	Blue
C	Clear
G	Green
R	Red★

g

Contact Block(s)	
Standard	
Code	Description
Blank	No contacts
D1	1 N.O.
D2	1 N.C.
A	1 N.O. - 1 N.C.
A2	2 N.O.
A4	2 N.C.
A7	1 N.C.L.B. - 1 N.C.
B	2 N.O. - 2 N.C.♣

h

Contact Block Termination Type▽	
Code	Description
Blank	Stab terminals
K	Large screw

★ Red flush head push buttons are not suitable for applications requiring extended head or other unguarded buttons capable of being operated quickly in emergencies, and they may not comply with applicable codes or standards.

‡ Grey bezels can be ordered separately.

§ LEDs are only available in red, green, amber, and white; lens color must match LED color.

♣ White LED available in 24V AC/DC only.

Δ LED only.

♦ Packet of colored inserts, one of each color. Not available with LED option for illuminated devices.

♣ Only available with full voltage illumination option and standard stab terminations.

▽ Logic Reed and small screw contact blocks must be ordered separately.

Pilot Light Units



Pilot Light
Cat. No. 800MB-CQ24RS



Push-to-Test Pilot Light
Cat. No. 800MB-CPT16G

800 MB – CP L 24 R

a
b
c
d
e
f

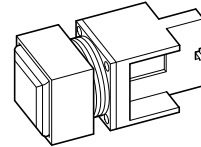

a

Bezel Color▲	
Code	Color
MB	Black

b

Power Module Type	
Code	Description
CP	Transformer
CQ	Full voltage

c

Illumination Options	
Code	Description
Blank	Incandescent
L	LED★
T	Push-to-test
TL	Push-to-test with LED★

d

Voltage	
Full Voltage	
Code	Description
12	12V AC/DC
24	24V AC/DC
10	120V AC§
Transformer	
Code	Description
16	120V AC
26	240V AC

e

Lens Color	
Code	Color
X	Packet of colored inserts✦
A	Amber
B	Blue
C	Clear/white
G	Green
R	Red

f

Termination Type▽	
Pilot Lights	
Code	Description
Blank	Stab terminals
Push-to-Test Pilot Lights	
Code	Description
Blank	Stab terminals
K	Large screw△

★ LEDs are only available in red, green, amber, and white; lens color must match LED color.

§ LED only.

✦ Packet of colored inserts, one of each color. Not available with LED illumination option.

△ Only available with full voltage power module and standard stab terminations.

▲ Grey bezel can be ordered separately.

▽ Small screw contact blocks must be ordered separately.

Specifications ★

Electrical Ratings		
Contact Ratings	Refer to the Contact Ratings tables below.	
Dielectric Strength	1600V for one minute 1300V for one minute (Logic Reed)	
Electrical Design Life Cycles	750 000 at maximum rated load 200 000 at maximum rated load (Logic Reed)	
Mechanical Ratings		
Vibration	10...2000 Hz 1.52 mm displacement (peak-to-peak) Max./10 G Max. (except Logic Reed)	
Shock	1/2 cycle sine wave for 11 milliseconds \geq 25 G (contact fragility) and no damage at 100 G	
Degree of Protection	Type 13; IEC I44 IP65 Oiltight	
Mechanical Design Life Cycles		
Push Buttons	1 000 000 minimum	
Potentiometers	100 000 minimum	
All other devices	200 000 minimum	
Contact Operation	Contact blocks with Bifurcated spanner: Slow make and break, simple break. Logic Reed Contact Blocks: Snap-action	
Typical Operating Forces		
Operators without contact blocks	2.45 lb (10.8 N)	
Push-Pull Units	8 lb (35.3 N) push to in position 4 lb (17.7 N) maximum pull to out position	
Contact Blocks	Standard — 1.5 lb (6.7 N) Logic Reed — 0.616 lb (2.6 N)	
Environment		
Temperature Range	Operating	32...131 °F (0...55 °C)
	Storage	-40...+185 °F (-40...+85 °C)
Note: Operating temperatures at +32 °F (0 °C) are based on the absence of freezing moisture and liquids.		
Humidity	50% at 104 °F (40 °C)	
Panel Thickness Requirements	1/16...1/4 in. (1.6...6.4 mm)	

★ Performance Data — see note on page 3.

Certifications

UL Listed —File: E14840,
E10314
Guide: NKCR, NOIV
CSA Certified: LR1234, LR11924
IEC Compliance, IEC 529

Standard Contact Ratings

(IEC 337-1) (NEMA ICS 2-125) Maximum continuous current I^{th} 10 A. Bulletin 800M units have control circuit ratings with 800M contact blocks as follows:

Maximum Operational Volts Ue	Utilization Category		Rated Operational Currents		
	IEC	NEMA	Volts Ue	Make	Break
AC 300	AC-II	A300	120...300	7200 VA	720 VA
			72...120	60 VA	720 VA
			24...72‡	60 A	10 A

‡ For applications below 24V and 24 mA, Logic Reed contacts are recommended.

Logic Reed Contact Ratings

Maximum: 150V AC, 0.15 A, 8 VA and 30V DC, 0.06 A, 1.8 VA. Should only be used with resistive loads.

Wire Capacity

Stab Termination Contact Blocks —

Accepts two 0.110 x 0.032 in. push-on connectors or one 0.250 x 0.032 in. push-on connector.

Small Screw Contact Blocks —

Accepts one #14 or two #16 AWG solid or stranded wires.

Large Screw Termination Contact Blocks —

Accepts two #12 AWG solid or stranded wires.

Approximate Dimensions

Dimensions in inches (millimeters). Dimensions are not intended to be used for manufacturing purposes.

Bul. 800MR Extension in Front of Panel

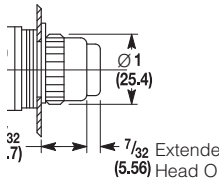

**Round Push Button
Flush, Extended and
Illuminated Extended**

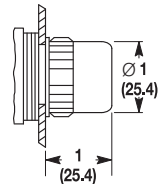

**Round Push Button
Illuminated Flush**

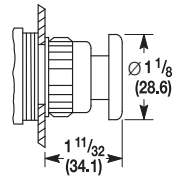

**Round Push Button
Mushroom**

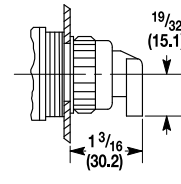

**Round Selector Switch
and Potentiometer
and Standard Knob**

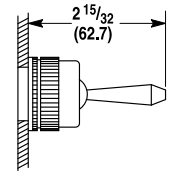

**Panel Wobble
Stick Unit**

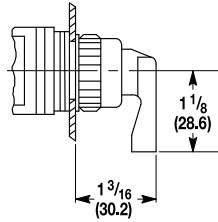

**Round Selector Switch
and Potentiometer
and Wing Lever**

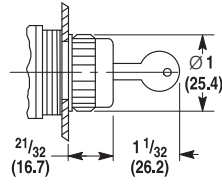

**Round Cylinder Lock
Selector Switch**

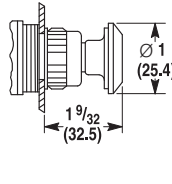

Round Push-Pull

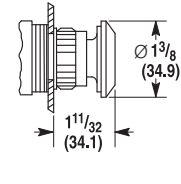

**Twist or Pull
Release Units**

Bul. 800MB Front View of Square Units

CAUTION: To avoid possible excessive heat, clusters of nine or more continuously illuminated units mounted in a small enclosure should be spaced at 1-1/2 in. (38.1 mm) minimum centers in one direction.

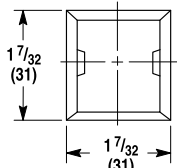

**Unit without Insert
and Backlit Unit**

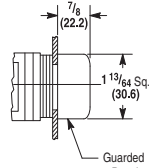

**Square Backlit
with Guarded Bezel**

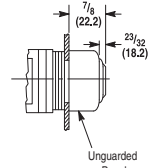

**Square Backlit
with Unguarded Bezel**

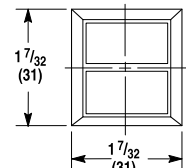

Dual Operator Unit

Bul. 800MB Extension in Front of Panel

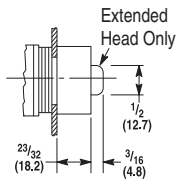

**Square Push Button
Flush and Extended**

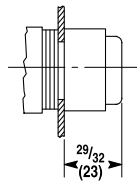

**Square Push Button
Large Extended**

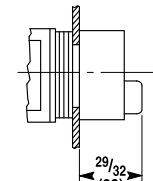

**Square Push Button
Dual Operator**

Dimensions in inches (millimeters). Dimensions are not intended to be used for manufacturing purposes.

Extension Behind Panel

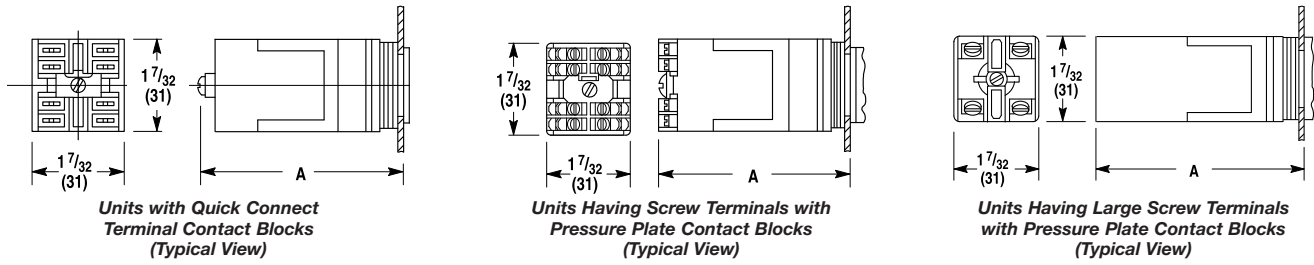

Units with Transformer



Contact Block Terminals Transformer Terminals

Panel Depth Requirements —

1/16...1/4 in. (1.6...6.4 mm)

Dimension A													
Description	Push Button	Pilot Light	Sel. Switch	Cyl. Lock	Pot.	Push-Pull or Twist Release	Push Button	Pilot Light	Sel. Switch	Cyl. Lock	Pot.	Push-Pull or Twist Release	
Non-Illuminated	Units with Quick Connect Terminals						Units Having Small Screw Terminals with Pressure Plates						
	2-1/4 (57.2)	—	2-15/32 (62.7)	3-1/2 (88.9)	2-1/32 (51.6)	2-3/4 (69.8)	2-5/16 (59)	—	2-17/32 (64.3)	3-9/16 (90.5)	2-1/32 (51.6)	2-13/16 (71.4)	
Illuminated	Full Voltage	2-1/4 (57.2)	2-1/4 (57.2)	2-15/32 (62.7)	—	—	2-3/4 (69.8)	2-25/32 (70.6)	2-25/32 (70.6)	2-17/32 (64.3)	—	—	2-13/16 (71.4)
	Transformer	2-23/32 (69.1)	2-23/32 (69.1)	2-29/32 (73.8)	—	—	3-3/32 (78.6)	2-25/32 (70.6)	2-25/32 (70.6)	2-31/32 (75.4)	—	—	3-5/32 (80.1)
Non-Illuminated							Units Having Large Screw Terminals with Pressure Plates						
							2-45/64 (68.6)	—	2-59/64 (74.2)	3-15/16 (100)	—	—	3-13/64 (81.4)
Illuminated					Full Voltage		3-11/64 (80.6)	3-11/64 (80.6)	3-23/64 (85.3)	—	—	—	3-13/64 (81.4)
					Transformer		3-11/64 (80.6)	3-11/64 (80.6)	3-23/64 (85.3)	—	—	—	—

Approximate Mounting Dimensions

Caution: To avoid possible excessive heat, clusters of nine or more continuously illuminated units mounted in a small enclosure should be spaced at 1-1/2 in. (38.1 mm) minimum centers in one direction.

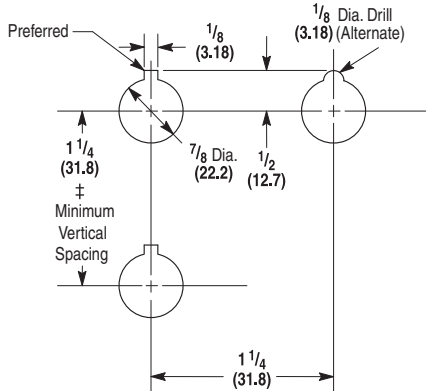

‡ Large screw terminal contact blocks require a minimum vertical spacing of 1-37/64 in. (40 mm); selector switches with wing lever knobs require 2-1/4 in. (57.1 mm) vertical and horizontal minimum spacing and large round legend plates require 1-1/2 in. (38.1 mm) minimum spacing.

Shipping Weights in Ounces (kg)							
Type of Unit		Weight	Type of Unit		Weight		
Push Buttons	Non-Illuminated	3-1/4 (0.09)	Selector Switches	Non-Illuminated	4 (0.11)		
	Illuminated	Full Voltage		3-1/2 (0.10)	Illuminated	Full Voltage	4 (0.11)
		Transformer	5 (0.14)			Transformer	5-1/2 (0.16)
Pilot Lights	Pilot Light	2-1/4 (0.06)	Push-Pull Units	Non-Illuminated		4-1/2 (0.13)	
	Push-to-Test	3 (0.09)		Illuminated	Full Voltage	4-1/2 (0.13)	
	Pilot Light	4-1/2 (0.13)				Transformer	5-1/2 (0.16)
	Push-to-Test	5 (0.14)					
Cylinder Lock		6 (0.17)	Potentiometer Units		4 (0.11)		

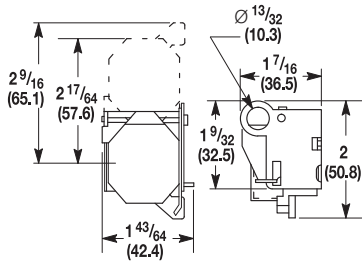

Padlocking Cover★
Cat. No. 800MR-N6

★ When using a padlocking cover and depending upon the types of adjacent units involved, the minimum vertical or horizontal spacing may have to be increased for operating clearance.

Dimensions in inches (millimeters). Dimensions are not intended to be used for manufacturing purposes.

Legend Plates

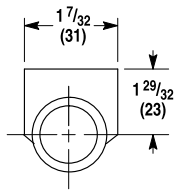

Standard Half Round Legend Plate★

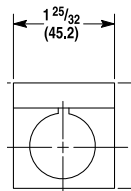

Standard Legend Plate§

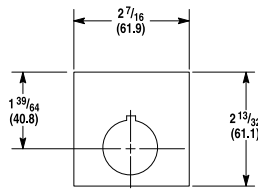

Large Size‡

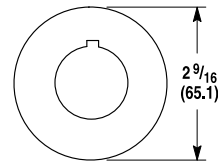

Round‡

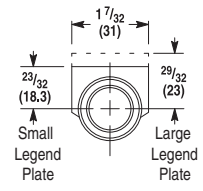

Small/Large Legend Plate

★ The Bulletin 800MR large half round legend plates are not recommended for use with the twist-release units because of the operator knob size. The legend plate is virtually unreadable. Push-pull units can be mounted in a 1-1/4 in. minimum horizontal spacing when no legend plate is used. Vertical spacing is 1-1/2 in. when the Bulletin 800MR large half round legend plate is used.

‡ These Bulletin 800MR legend plates consist of Bulletin 800T legend plates with Cat. No. 800MR-N50 adapter rings.

Important User Information

Read this document and the documents listed in the additional resources section about installation, configuration, and operation of this equipment before you install, configure, operate, or maintain this product. Users are required to familiarize themselves with installation and wiring instructions in addition to requirements of all applicable codes, laws, and standards.

Activities including installation, adjustments, putting into service, use, assembly, disassembly, and maintenance are required to be carried out by suitably trained personnel in accordance with applicable code of practice.

If this equipment is used in a manner not specified by the manufacturer, the protection provided by the equipment may be impaired.

In no event will Rockwell Automation, Inc. be responsible or liable for indirect or consequential damages resulting from the use or application of this equipment.

The examples and diagrams in this manual are included solely for illustrative purposes. Because of the many variables and requirements associated with any particular installation, Rockwell Automation, Inc. cannot assume responsibility or liability for actual use based on the examples and diagrams.

No patent liability is assumed by Rockwell Automation, Inc. with respect to use of information, circuits, equipment, or software described in this manual.

Reproduction of the contents of this manual, in whole or in part, without written permission of Rockwell Automation, Inc., is prohibited.

Documentation Feedback

Your comments will help us serve your documentation needs better. If you have any suggestions on how to improve this document, complete this form, publication [RA-DU002](#), available at <http://www.rockwellautomation.com/literature/>.

Allen-Bradley, Rockwell Software, Rockwell Automation, and LISTEN. THINK. SOLVE are trademarks of Rockwell Automation, Inc.
Trademarks not belonging to Rockwell Automation are property of their respective companies.

Rockwell Otomasyon Ticaret A.Ş., Kar Plaza İş Merkezi E Blok Kat:6 34752 İçerenköy, İstanbul, Tel: +90 (216) 5698400

www.rockwellautomation.com

Power, Control and Information Solutions Headquarters

Americas: Rockwell Automation, 1201 South Second Street, Milwaukee, WI 53204-2496 USA, Tel: (1) 414.382.2000, Fax: (1) 414.382.4444
Europe/Middle East/Africa: Rockwell Automation NV, Pegasus Park, De Kleetlaan 12a, 1831 Diegem, Belgium, Tel: (32) 2 663 0600, Fax: (32) 2 663 0640
Asia Pacific: Rockwell Automation, Level 14, Core F, Cyberport 3, 100 Cyberport Road, Hong Kong, Tel: (852) 2887 4788, Fax: (852) 2508 1846