

SLG23XEE40KG/2M/BS

Flow sensors

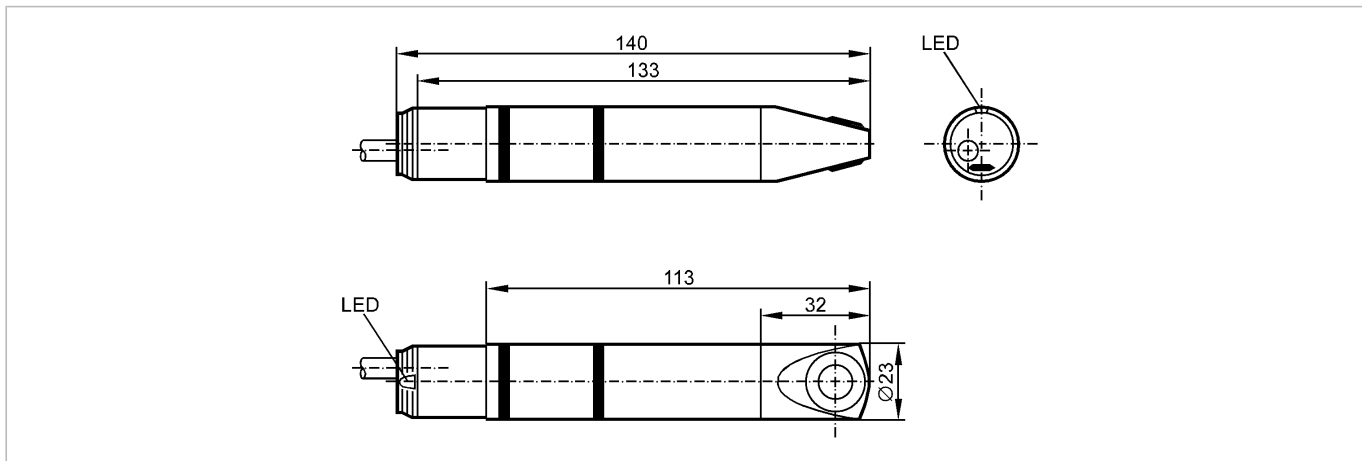

Product characteristics

Airflow monitor

Cylindrical type

Process connection: Ø 23 mm

Analog output

Application

Pressure rating [bar]

1

Medium temperature Gases [°C]

35...65

Electrical data

Electrical design

DC

Operating voltage [V]

24 DC ± 10 %

Current consumption [mA]

< 35

Insulation resistance [MΩ]

> 100 (500 V DC)

Outputs

Output function

0...10 V analog

Measuring / setting range

Flow range [cm/s]

200...2000 (= 1...10 V)

Accuracy / deviations

Max. temperature gradient of medium [K/min]

1

Reaction times

Power-on delay time [s]

90

Environment

Ambient temperature [°C]

-10...50

Max. relative air humidity [%]

90

Protection

IP 54

Tests / approvals

MTTF [Years]

726

Mechanical data

Process connection

Ø 23 mm

Materials (wetted parts)

PBT; titanium

Housing materials

housing: PBT; sensor surface: titanium

Weight [kg]

0.207

Displays / operating elements

Display

Power LED green

Electrical connection

Connection

Cable with M16 connector / 2 m; 4 x 0.5 mm²

Wiring

SL5201 - Airflow monitor - eclass: 27200802 / 27-20-08-02

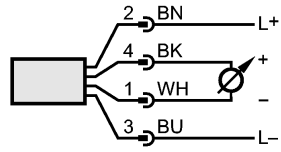

Accessories

Accessories (included)

Mounting clamp (E40048)

Remarks

Pack quantity

[piece]

1