

**SI5004**

SID10ADB10OG/

Flow sensors

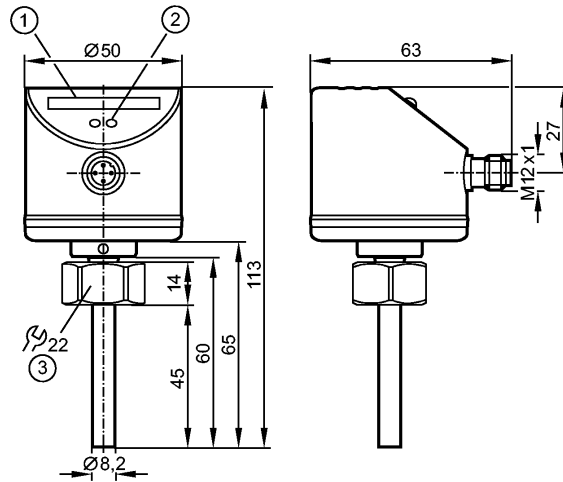

- 1: LED display
- 2: setting pushbutton
- 3: tightening torque 25 Nm



**Product characteristics**

Flow transmitter	
Compact type for adapter	
Process connection: internal thread M18 x 1.5 for adapter	
Analog output	
Setting range: 3...300 cm/s (liquids)	

**Application**

Application		liquids
Pressure rating [bar]		300
Medium temperature [°C]		-25...80

**Electrical data**

Electrical design		DC
Operating voltage [V]		19...36 DC
Current consumption [mA]		< 60
Protection class		III
Reverse polarity protection		yes

**Outputs**

Output function		4...20 mA analog
Overload protection		yes
Analog output		4...20 mA, max. 22 mA
Max. load [Ω]		500

**Measuring / setting range**

Liquids		
Setting range [cm/s]		3...300
Greatest sensitivity [cm/s]		3...100
Gases		
Setting range [cm/s]		-

**Accuracy / deviations**

Repeatability [cm/s]		1...5 *)
----------------------	--	----------

## SI5004

SID10ADB10OG/

Flow sensors

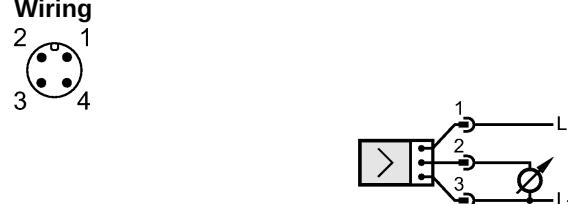
Temperature drift	[cm/s x 1/K]	0.1 **)
Accuracy		± 2...± 10 cm/s *)
<b>Reaction times</b>		
Power-on delay time	[s]	10
Response time	[s]	1...10
<b>Environment</b>		
MAWP (for applications according to CRN)	[bar]	208
Ambient temperature	[°C]	-25...80
Storage temperature	[°C]	-25...100
Protection		IP 67
<b>Tests / approvals</b>		
EMC		DIN EN 61000-6-2 DIN EN 61000-6-3
Shock resistance		DIN EN 60068-2-27 50 g (11 ms)
Vibration resistance		DIN EN 60068-2-6 20 g (55...2000 Hz)
MTTF	[Years]	259
<b>Mechanical data</b>		
Process connection		internal thread M18 x 1.5 for adapter
Materials (wetted parts)		stainless steel 316L / 1.4404; O-ring: FKM 8 x 1.5 gr 80° Shore A
Housing materials		stainless steel 316L / 1.4404; stainless steel (304S15); PC; PBT-GF 20; EPDM/X
Weight	[kg]	0.234
<b>Displays / operating elements</b>		
Function display	LED	10 LEDs, three-colour
<b>Electrical connection</b>		
Connection		M12 connector
<b>Wiring</b>		
		
<b>Remarks</b>		
Remarks		*) for water; 5...100 cm/s; 25°C (factory setting) **) for water; 5...100 cm/s; 10...70°C
Pack quantity	[piece]	1