

no longer available - archive entry replaced by: SF3020
 Product still available through ifm USA

efector300
 SF3020



SFN12ABBE1/6M

Flow sensors

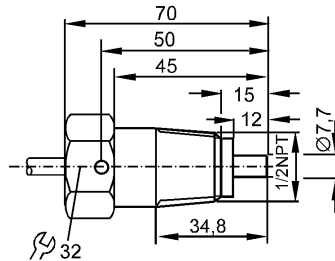

Product characteristics

Flow sensor for connection to evaluation units

Threaded type

Cable

Process connection: 1/2" NPT

Grounding screw 8-32 UNC

Application

Application

CLASS I, DIV. 1, GROUPS A, B, C and D
 CLASS II / III, DIV. 1, GROUPS E, F and G

Pressure rating [bar]

30

Medium temperature [°C]

-25...100

Electrical data

Connection to control monitor

VS3000

Measuring / setting range

Liquids

Setting range [cm/s]

3...300

Greatest sensitivity [cm/s]

3...60

Gases

Setting range [cm/s]

200...2000

Greatest sensitivity [cm/s]

200...800

Accuracy / deviations

Max. temperature gradient of medium [K/min]

15

Reaction times

Response time [s]

1...10

Environment

Protection

IP 67

Tests / approvals

Approval

FM J.I. OX9A8.AE (3615) 702053

Shock resistance

DIN IEC 68-2-27: 40 g (11 ms)

Vibration resistance

DIN IEC 68-2-6: 10 g (55...2000 Hz)

MTTF [Years]

7983

Safety classification

Temperature class

T4

Mechanical data

Process connection

1/2" NPT

Materials (wetted parts)

stainless steel 316Ti / 1.4571

SF3020 - Flow sensor for connection to evaluation units - eclass: 27273101 / 27-27-31-01

Housing materials		stainless steel 316Ti / 1.4571
Probe length L	[mm]	15
Installation length EL	[mm]	45
Weight	[kg]	0.549
Electrical connection		
Connection		silicone-sheated cable / 6 m; 5 x 0.34 mm ²
Max. cable length	[m]	100 (5 x 0.5mm ²)

Wiring

Core colors

- BN brown
- BU blue
- BK black
- WH white
- GY grey

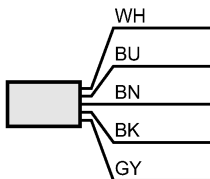

Remarks

Pack quantity	[piece]	1
---------------	---------	---

ifm efector, inc. • 1100 Atwater Drive • Malvern • PA 19355 — We reserve the right to make technical alterations without prior notice. — US — SF3020 — 21.09.2012

no longer available - archive entry replaced by: SF3020

Product still available through ifm USA