

OG5129

OGS-00KG/US/90°

Photoelectric sensors

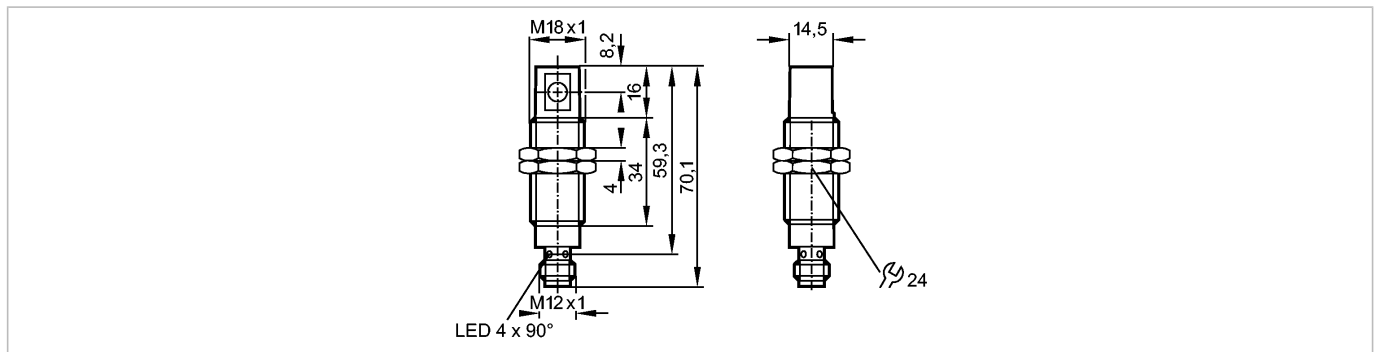

Product characteristics	
Through-beam sensor	
Threaded type	
Quick disconnect	
Transmitter	
Sensing range 9m	
Electrical data	
Electrical design	DC
Operating voltage [V]	10...30 DC
Current consumption [mA]	< 19
Type of light	red light 660 nm
Protection class	II
Reverse polarity protection	yes
Outputs	
Voltage drop [V]	< 2.5
Short-circuit protection	yes (non-latching)
Overload protection	yes
Monitoring range	
Sensing range [m]	9
Light spot diameter [mm]	< 3000 (at maximum range)
Environment	
Ambient temperature [°C]	-25...60
Protection	IP 68
Tests / approvals	
EMC	EN 60947-5-2 EN 55011: class B
MTTF [Years]	1714
Mechanical data	
Housing materials	high-grade stainless steel; ABS
Lens material	PMMA
Weight [kg]	0.065
Displays / operating elements	
Power LED	green
Electrical connection	
Connection	M12 connector

OG5129

OGS-00KG/US/90°

Photoelectric sensors

Wiring

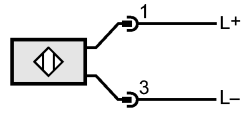

Accessories

Accessories (included)

2 nuts; 2 lock washers (Steel galvanized)

Remarks

Pack quantity

[piece]

1