

**OG5127**

OGE-HPKG/US/90°

Photoelectric sensors

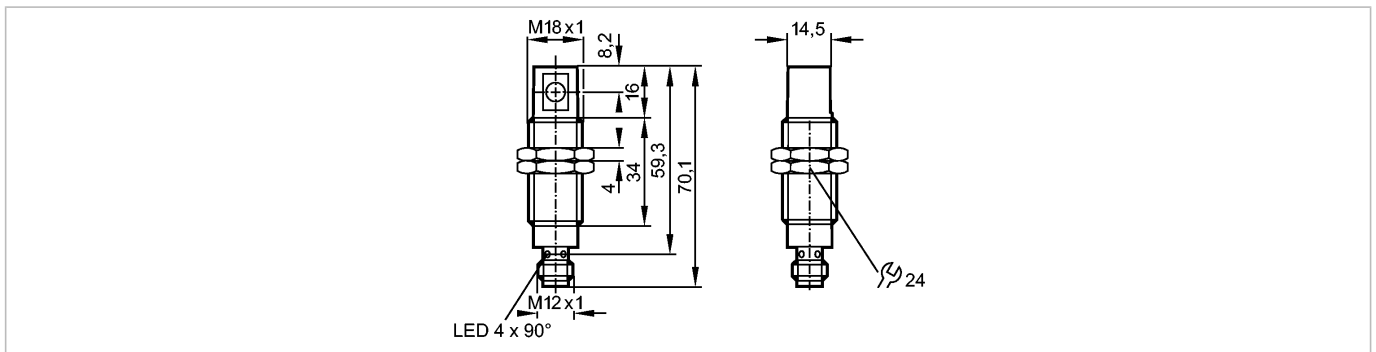

**Product characteristics**

Through-beam sensor
Threaded type
Quick disconnect
Receiver
Sensing range 9m

**Electrical data**

Electrical design	DC PNP
Operating voltage [V]	10...30 DC
Current consumption [mA]	< 12
Type of light	red light 660 nm
Protection class	II
Reverse polarity protection	yes

**Outputs**

Output function	light-on mode
Voltage drop [V]	< 2.5
Current rating [mA]	200
Short-circuit protection	yes (non-latching)
Overload protection	yes
Switching frequency [Hz]	500

**Monitoring range**

Sensing range [m]	9
-------------------	---

**Environment**

Ambient temperature [°C]	-25...60
Protection	IP 68

**Tests / approvals**

EMC	EN 60947-5-2 EN 55011:	class B
MTTF [Years]		953

**Mechanical data**

Housing materials	high-grade stainless steel; ABS
Lens material	PMMA
Weight [kg]	0.065

**Displays / operating elements**

Output status indication	LED	yellow
--------------------------	-----	--------

**OG5127**

OGE-HPKG/US/90°

Photoelectric sensors

Power LED green

**Electrical connection**

Connection M12 connector

**Wiring**

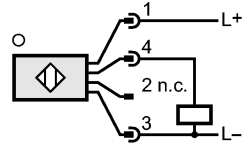

**Accessories**

Accessories (included) 2 nuts; 2 lock washers (Steel galvanized)

**Remarks**

Pack quantity [piece] 1