

no longer available - archive entry replaced by: OGP700

efector200

OG5061



OGPLFPKG/B6/V4A/US-100

Photoelectric sensors

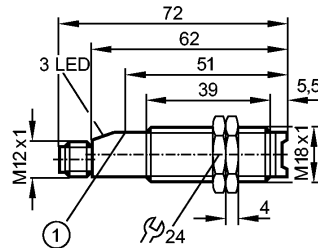

1: pushbutton



Product characteristics

Retro-reflective sensor

Threaded type

M18 x 1

Quick disconnect

Polarization filter

Function check output

Visible laser light, protection class 2 laser

gold-plated contacts

Sensing range 0.2...13m (Prismatic reflector Ø 80 (E20005))

adjustable

Electrical data

Electrical design

DC PNP

Operating voltage [V]

10...30 DC

Current consumption [mA]

< 30 *)

Type of light

red light 675 nm

Life expectancy typ. [h]

50000

Protection class

II

Reverse polarity protection

yes

Outputs

Output function

light-on / dark-on programmable

Voltage drop

- Switching output [V]

< 2.5

- Function check output [V]

< 3.5

Current rating

- Switching output [mA]

200

- Function check output [mA]

10

Short-circuit protection

yes (non-latching)

Overload protection

yes

Switching frequency [Hz]

500

Monitoring range

Sensing range [m]

0.2...13 (Prismatic reflector Ø 80 (E20005))

Smallest detectable object [mm]

Ø 3 mm (1 m) / Ø 7 mm (5 m) / Ø 12 mm (10 m) / Ø 15 mm (13 m)

Light spot diameter [mm]

< 25 (at maximum range)

Excess gain graphs

OG5061 - Retro-reflective sensor - eclass: 27270902 / 27-27-09-02

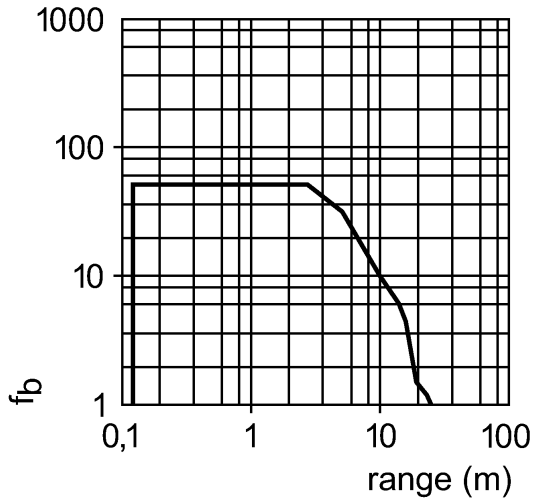

| | |
|-------------------------------|-------------------------------------|
| Environment | |
| Ambient temperature [°C] | -10...50 |
| Protection | IP 67 |
| Tests / approvals | |
| EMC | EN 60947-5-2 EN 55011: class B |
| Mechanical data | |
| Housing materials | stainless steel 316L / 1.4404; PBT |
| Lens material | PMMA |
| Weight [kg] | 0.076 |
| Displays / operating elements | |
| Output status indication LED | yellow |
| Power LED | green |
| Function display LED | red |
| Electrical connection | |
| Connection | M12 connector; gold-plated contacts |

Wiring

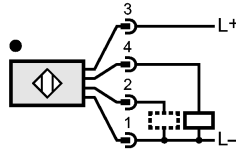
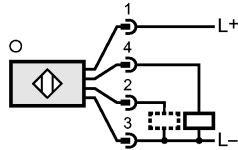

2: function check

| | |
|------------------------|---|
| Accessories | |
| Accessories (included) | 2 lock nuts |
| Remarks | |
| Remarks | <p>Caution: Laser Light Power <= 2.2 mW wavelength = 675 nm Frequency = 2.2 kHz pulse length = 24 μs Do not stare into beam Avoid exposure to the laser light Class 2 laser product EN60825-1 July 1994 *) Operating; < 50 mA setting mode</p> |
| Pack quantity [piece] | 1 |