

no longer available - archive entry replaced by: OGH700

efector200

OG5056



OGTLFPKG/B5/V4A/US-100

Photoelectric sensors

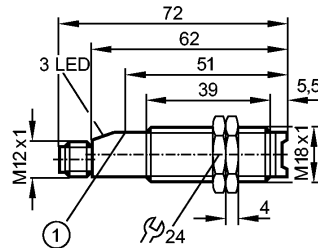

1: pushbutton



Product characteristics

Diffuse reflection sensor

Threaded type

M18 x 1

Quick disconnect

Function check output

Visible laser light, protection class 2 laser

gold-plated contacts

Range 1...150mm (Range referred to white paper 200 x 200 mm, 90 % remission)

adjustable

Electrical data

Electrical design

DC PNP

Operating voltage [V]

10...30 DC

Current consumption [mA]

< 30 *)

Type of light

red light 675 nm

Life expectancy typ. [h]

50000

Protection class

II

Reverse polarity protection

yes

Outputs

Output function

light-on / dark-on programmable

Voltage drop

- Switching output [V]

< 2.5

- Function check output [V]

< 3.5

Current rating

- Switching output [mA]

200

- Function check output [mA]

10

Short-circuit protection

yes (non-latching)

Overload protection

yes

Switching frequency [Hz]

500

Monitoring range

Range [mm]

1...150 (Range referred to white paper 200 x 200 mm, 90 % remission)

Smallest detectable object [mm]

**)

Light spot diameter [mm]

0.1 (Range 50 mm)

Excess gain graphs

OG5056 - Diffuse reflection sensor - eclass: 27270903 / 27-27-09-03

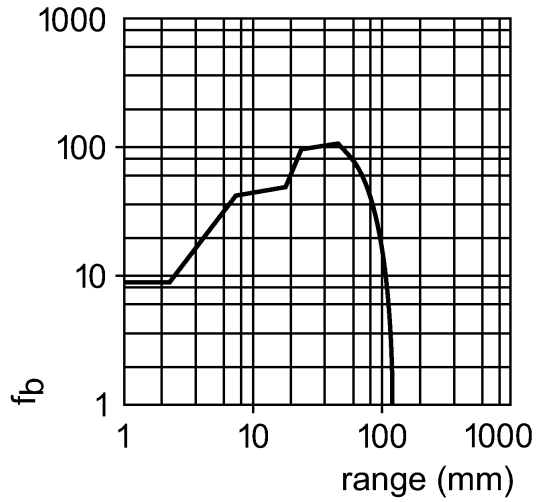

Environment	
Ambient temperature [°C]	-10...50
Protection	IP 67
Tests / approvals	
EMC	EN 60947-5-2 EN 55011: class B
MTTF [Years]	429
Mechanical data	
Housing materials	stainless steel 316L / 1.4404; PBT
Lens material	PMMA
Weight [kg]	0.075
Displays / operating elements	
Output status indication LED	yellow
Power LED	green
Function display LED	red
Electrical connection	
Connection	M12 connector; gold-plated contacts

Wiring

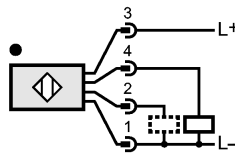
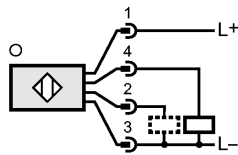

2: function check

Accessories	
Accessories (included)	2 lock nuts
Remarks	
Remarks	<p>Caution: Laser Light</p> <p>Power <= 2.2 mW wavelength = 675 nm</p> <p>Frequency = 2.2 kHz pulse length = 24 μs</p> <p>Do not stare into beam</p> <p>Avoid exposure to the laser light</p> <p>Class 2 laser product</p> <p>EN60825-1 July 1994</p> <p>*) Operating; < 50 mA setting mode</p>

OG5056 - Diffuse reflection sensor - eclass: 27270903 / 27-27-09-03

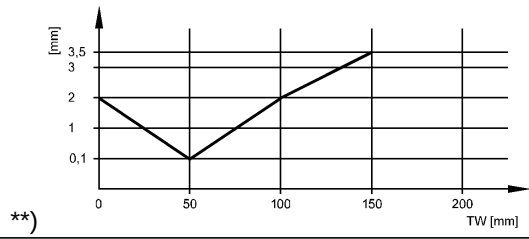

Pack quantity [piece]

1

ifm efector, inc. • 1100 Atwater Drive • Malvern • PA 19355 — We reserve the right to make technical alterations without prior notice. — US — OG5056 — 06.03.2003
no longer available - archive entry replaced by: OGH700