

no longer available - archive entry replaced by: OGE503

**efector200**

OG5044



OGE-FNKG/US-100

Photoelectric sensors

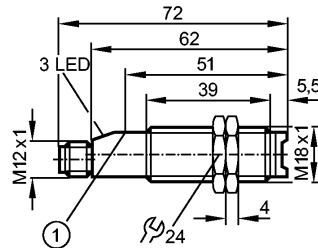

1: pushbutton



Product characteristics

Through-beam sensor

Threaded type

M18 x 1

Quick disconnect

Function check output

gold-plated contacts

Receiver

Sensing range 15m

adjustable

Electrical data

Electrical design

DC NPN

Operating voltage [V]

10...36 DC

Current consumption [mA]

< 24

Type of light

Infrared light 880 nm

Protection class

II

Reverse polarity protection

yes

Outputs

Output function

light-on / dark-on programmable

**Voltage drop**

- Switching output [V]

< 2.5

- Function check output [V]

< 3.5

**Current rating**

- Switching output [mA]

200

- Function check output [mA]

10

Short-circuit protection

yes (non-latching)

Overload protection

yes

Switching frequency [Hz]

500

Monitoring range

Sensing range [m]

15

**Excess gain graphs**

**OG5044 - Through-beam sensor - eclass: 27270901 / 27-27-09-01**

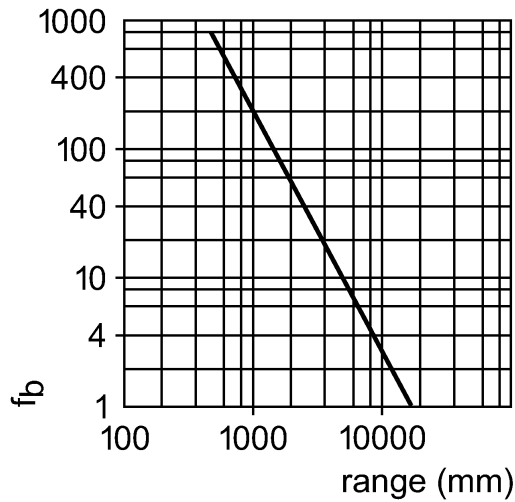

Environment	
Ambient temperature [°C]	-25...80
Protection	IP 67
Tests / approvals	
EMC	EN 60947-5-2 EN 55011: class B
MTTF [Years]	494
Mechanical data	
Housing materials	PBT (Pocan)
Lens material	PMMA
Weight [kg]	0.044
Displays / operating elements	
Output status indication LED	yellow
Power LED	green
Function display LED	red
Electrical connection	
Connection	M12 connector; gold-plated contacts

**Wiring**

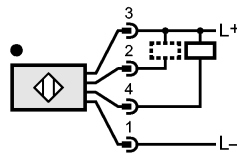
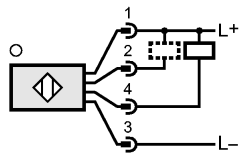

2: function check

Accessories	
Accessories (included)	2 lock nuts
Remarks	
Pack quantity [piece]	1