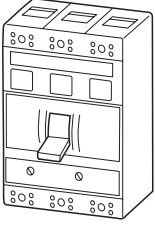
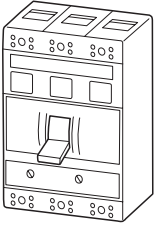

Inverse Time Circuit Breakers, 150A, 600V AC

Thermal-magnetic Type NZM 7...-NA

UL / CSA ; IEC / EN 60 947-2 ; CE

	Continuous Current Rating I_u A	Fixed Thermal Setting A	Magnetic Trip Setting for Instantaneous Response A	UL/CSA Interrupting Ratings (AC, 60Hz) kA RMS symmetrical @			Type Article No.	Price see price list	
				240V	480V	600V			
				Normal Interrupting Capacity 25 kA at 480 V 50/60 Hz 14 kA at 600 V 50/60 Hz					
With fixed thermal setting and pressure wire terminals									
	40	25	380	65	25	14	NZM7A-25N-NA 208658		
		30	380				NZM7A-30N-NA 208659		
		35	380				NZM7A-35N-NA 208660		
		40	380				NZM7A-40N-NA 208661		
	60	50	378 - 760	NZM7A-50N-NA 208662					
		60	378 - 760	NZM7A-60N-NA 208663					
	80	70	480 - 960	NZM7A-70N-NA 208664					
		80	480 - 960	NZM7A-80N-NA 208665					
	100	90	600 - 1200	NZM7A-90N-NA 208666					
		100	600 - 1200	NZM7A-100N-NA 208667					
	125	125	750 - 1500	NZM7A-125N-NA 208668					
	150	150	960 - 1900	NZM7A-150N-NA 210086					
	With fixed thermal setting and provisions for bolt-on connection								
		40	25	380	65	25	14	NZM7A-25N-NA-M8 208669	
30			380	NZM7A-30N-NA-M8 208670					
35			380	NZM7A-35N-NA-M8 208671					
40			380	NZM7A-40N-NA-M8 208672					
60		50	378 - 760	NZM7A-50N-NA-M8 208673					
		60	378 - 760	NZM7A-60N-NA-M8 208674					
80		70	480 - 960	NZM7A-70N-NA-M8 208675					
		80	480 - 960	NZM7A-80N-NA-M8 208676					
100		90	600 - 1200	NZM7A-90N-NA-M8 208677					
		100	600 - 1200	NZM7A-100N-NA-M8 208678					
125		125	750 - 1500	NZM7A-125N-NA-M8 208679					
150		150	960 - 1900	NZM7A-150N-NA-M8 210087					

Notes:

- Type **NZM7A-...N(S)-NA(-M8)** molded-case circuit breakers are UL listed (UL 489) and CSA certified (22.2 No.. 5.1) Inverse Time, 150A Thermal-magnetic Trip Circuit Breakers with a fixed thermal trip feature and an adjustable magnetic trip function (In breakers rated 25 to 40A, the magnetic trip function is fixed at 380A).
- NZM7A-..N(S)-NA are supplied as standard with pressure wire terminals to accept cable connection, but are also suitable for bolt-on connections using crimped lugs or straight lengths of Cu busbar (type suffix "-M8").

Inverse Time Circuit Breakers, 150A, 600V AC

Thermal-magnetic Type NZM7...-NA

UL / CSA ; IEC / EN 60 947-2 ; CE

High Interrupting Capacity 50 kA at 480 V 50/60 Hz			Type	Price
22 kA at 600 V 50/60 Hz				
Fuseless current-limiting circuit breaker			Article No.	see price list
UL/CSA Interrupting Ratings (AC, 60Hz)				
kA RMS symmetrical @				
240V	480V	600V		

100	50	22	NZM7A-25S-NA 220936	
			NZM7A-30S-NA 220937	
			NZM7A-35S-NA 220938	
			NZM7A-40S-NA 220939	
			NZM7A-50S-NA 220940	
			NZM7A-60S-NA 220941	
			NZM7A-70S-NA 220942	
			NZM7A-80S-NA 220943	
			NZM7A-90S-NA 220944	
			NZM7A-100S-NA 220945	
			NZM7A-125S-NA 220946	
			NZM7A-150S-NA 220947	

100	50	22	NZM7A-25S-NA-M8 220948	
			NZM7A-30S-NA-M8 220949	
			NZM7A-35S-NA-M8 220950	
			NZM7A-40S-NA-M8 220951	
			NZM7A-50S-NA-M8 220952	
			NZM7A-60S-NA-M8 220953	
			NZM7A-70S-NA-M8 220954	
			NZM7A-80S-NA-M8 220955	
			NZM7A-90S-NA-M8 220956	
			NZM7A-100S-NA-M8 220957	
			NZM7A-125S-NA-M8 220958	
			NZM7A-150S-NA-M8 220959	

Notes

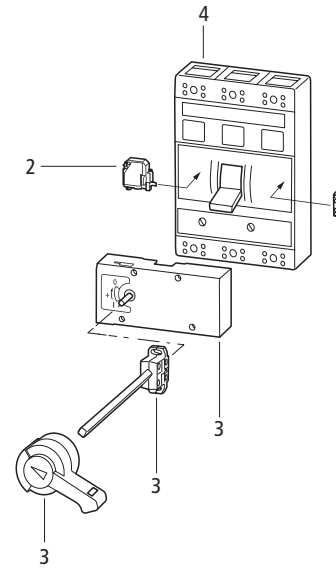

Accessories	Page
1 Auxiliary contacts	09/014
2 Voltage trips	09/016
3 Handles and operators	09/022
4 Terminals	09/028
Other accessories	09/022

Inverse Time Circuit Breakers, 150A, 600V AC

Thermal-magnetic Type NZM 7...-NA

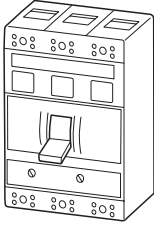
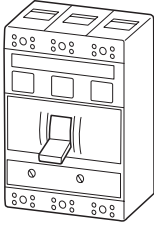
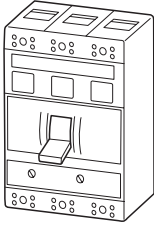
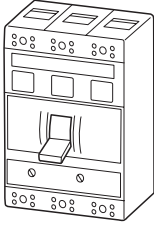
				Normal Interrupting Capacity			25 kA at 480 V 50/60 Hz 14 kA at 600 V 50/60 Hz	
	Continuous Current Rating	Adjustable Thermal Setting	Magnetic Trip Setting for Instantaneous Response	UL/CSA Interrupting Ratings (AC, 60Hz)			Type Article No.	Price see price list
	I_u A	A	A	kA RMS symmetrical @				
				240V	480V	600V		
With adjustable thermal setting and pressure wire terminals								
	40	25 - 40	380	65	25	14	NZM7-40N-NA 210076	
	63	40 - 63	378 - 760				NZM7-63N-NA 210077	
	80	63 - 80	480 - 960				NZM7-80N-NA 210078	
	100	80 - 100	600 - 1200				NZM7-100N-NA 210079	
	125	80 - 125	750 - 1500				NZM7-125N-NA 207875	
	150	125 - 150	960 - 1900				NZM7-150N-NA 210084	
With adjustable thermal setting and provisions for bolt-on connection								
	40	25 - 40	380	65	25	14	NZM7-40N-NA-M8 210080	
	63	40 - 63	378 - 760				NZM7-63N-NA-M8 210081	
	80	63 - 80	480 - 960				NZM7-80N-NA-M8 210082	
	100	80 - 100	600 - 1200				NZM7-100N-NA-M8 210083	
	125	80 - 125	750 - 1500				NZM7-125N-NA-M8 207839	
	150	125 - 150	960 - 1900				NZM7-150N-NA-M8 210085	
				High Interrupting Capacity			50 kA at 480 V 50/60 Hz 22 kA at 600 V 50/60 Hz	
With adjustable thermal setting and pressure wire terminals								
	40	25 - 40	380	100	50	22	NZM7-40S-NA 220961	
	63	40 - 63	378 - 760				NZM7-63S-NA 220962	
	80	63 - 80	480 - 960				NZM7-80S-NA 220963	
	100	80 - 100	600 - 1200				NZM7-100S-NA 220964	
	125	80 - 125	750 - 1500				NZM7-125S-NA 220965	
	150	125 - 150	960 - 1900				NZM7-150S-NA 220966	
With adjustable thermal setting and provisions for bolt-on connection								
	40	25 - 40	380	100	50	22	NZM7-40S-NA-M8 220967	
	63	40 - 63	378 - 760				NZM7-63S-NA-M8 220968	
	80	63 - 80	480 - 960				NZM7-80S-NA-M8 220969	
	100	80 - 100	600 - 1200				NZM7-100S-NA-M8 220970	
	125	80 - 125	750 - 1500				NZM7-125S-NA-M8 220971	
	150	125 - 150	960 - 1900				NZM7-150S-NA-M8 220972	

Notes:

- Type NZM7-...N(S)-NA(-M8) molded-case circuit breakers are UL listed (UL 489) and CSA certified (22.2 No. 5.1) Inverse Time, 150A Thermal-magnetic Trip Circuit Breakers with an adjustable thermal trip feature and an adjustable magnetic trip function (In breakers rated 25 to 40A, the magnetic trip function is fixed at 380A).
- NZM7-...N(S)-NA molded case circuit breakers and NZM7-...-NA molded case switches are supplied as standard with pressure wire terminals to accept cable connection, but are also suitable for bolt-on connections using crimped lugs or straight lengths of Cu busbar (type suffix "-M8").