



Model Number

NJ10-30GM50-E2-C-V1

Features

- Weld Immune

Technical Data

General specifications

Switching element function	PNP	NO
Rated operating distance	s_n	10 mm
Installation		flush
Output polarity		switched high
Assured operating distance	s_a	0 ... 8.1 mm
Reduction factor r_{Al}		0.2
Reduction factor r_{Cu}		0.15
Reduction factor r_{304}		0.6

Nominal ratings

Operating voltage	U_B	10 ... 60 V
Switching frequency	f	0 ... 100 Hz
Reverse polarity protection		reverse polarity protected
Short-circuit protection		pulsing
Voltage drop	U_d	≤ 3 V
Operating current	I_L	0 ... 400 mA
No-load supply current	I_0	≤ 15 mA
Switching state indicator		LED, yellow

Standard conformity

Standards	IEC / EN 60947-5-2:2004
-----------	-------------------------

Ambient conditions

Ambient temperature	-25 ... 70 °C (-13 ... 158 °F)
---------------------	--------------------------------

Mechanical specifications

Core cross-section	-
Housing material	Brass, PTFE coated
Sensing face	PPS
Degree of protection	IP67

Dimensions

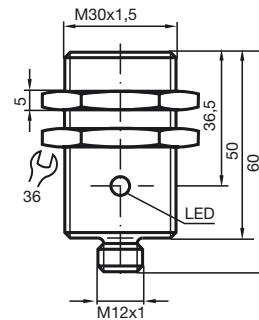

Electrical Connection

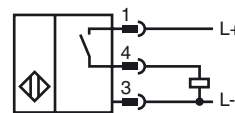

Pinout

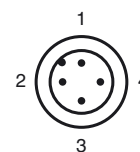

Release date: 2015-02-24 11:19 Date of issue: 2015-02-25 037961_eng.xml



Wire colors in accordance with EN 60947-5-2

1		BN	(brown)
2		WH	(white)
3		BU	(blue)
4		BK	(black)

Release date: 2015-02-24 11:19 Date of issue: 2015-02-25 037961_eng.xml