



Model Number

LED18-RRR-P

Red Pilot Light

Features

- 12 to 24 V DC
- Red light

Connection

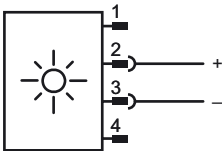

Pinout

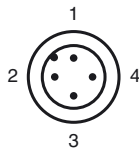

Accessories

V1-G-2M-PVC

Cable socket, M12, 4-pin, PVC cable

V1-W-2M-PVC

Cable socket, M12, 4-pin, PVC cable

Dimensions

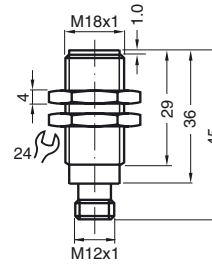

Technical Data

Electrical specifications

| | | |
|-------------------|-------|---------------------------------|
| Operating voltage | U_B | 12 ... 24 V DC |
| Operating current | | 12 V DC: 9 mA 24 V DC: 24 mA |

Ambient conditions

| | |
|---------------------|-----------------------------|
| Ambient temperature | 0 ... 60 °C (32 ... 140 °F) |
|---------------------|-----------------------------|

Mechanical specifications

| | |
|-------------------|--------------------------------|
| Connection type | Device connector M12 x 1 4-pin |
| Protection degree | IP67 |
| Material | brass, nickel-plated |