

no longer available - archive entry

efectoriso

KN0003



KNM30NUAFBOW/SL/OF

Capacitive sensors

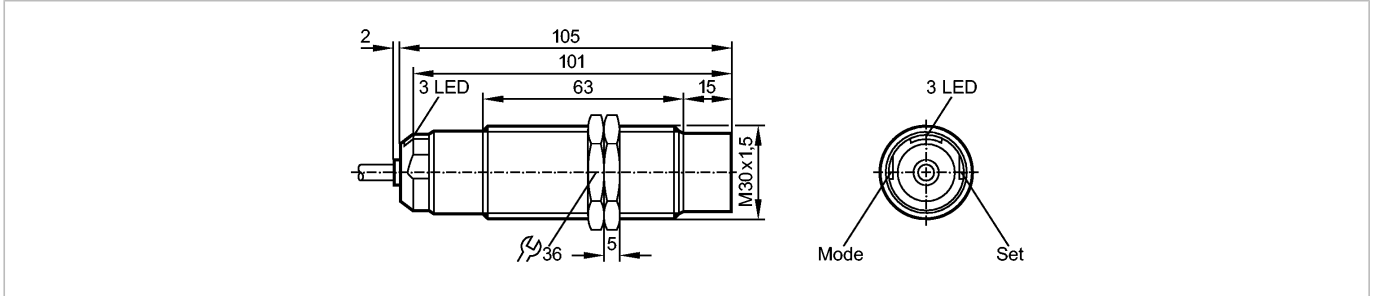

Product characteristics

Level sensor

Metal thread M30 x 1.5

Cable

Microprocessor

Programmable sensing range; [nfl] non-flush mountable

Application

Application For dry bulk material and liquids (detection through non-metallic vessel wall)

Electrical data

Electrical design

AC

Operating voltage [V]

30...250 AC (47...63 Hz)

Protection class

I

Outputs

Output function

normally open / closed programmable

Voltage drop [V]

< 10

Minimum load current [mA]

5

Leakage current [mA]

< 2.5 (250 V) / 1.7 (110 V)

Current rating

- Current rating (continuous) [mA]

150; 200 (...40 °C)

- Current rating (peak) [mA]

î: 1.0 A (20 ms / 0.5 Hz)

Switching frequency [Hz]

5

Environment

Ambient temperature [°C]

-25...80

Medium temperature [°C]

-25...100

Protection

IP 67

Tests / approvals

EMC

EN 60947-5-2

Mechanical data

Mounting

non-flush mountable

Housing materials

brass Optalloy-plated; PBT; PPS

Weight [kg]

0.352

Displays / operating elements

Output status indication LED

yellow

Setting aid LED

red (uncertain range) ; green (programming)

Electrical connection

Connection

PVC cable / 2 m; 3 x 0.5 mm²

Wiring

KN0003 - Level sensor - eclass: 27371813 / 27-37-18-13

Core colors

BN brown

BU blue

GN/YE green/yellow

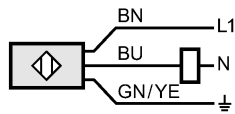

Accessories

Accessories (included)

2 lock nuts

Remarks

Pack quantity

[piece]

1

ifm efector, inc. • 1100 Atwater Drive • Malvern • PA 19355 — We reserve the right to make technical alterations without prior notice. — US — KN0003 — 21.07.2004

no longer available - archive entry