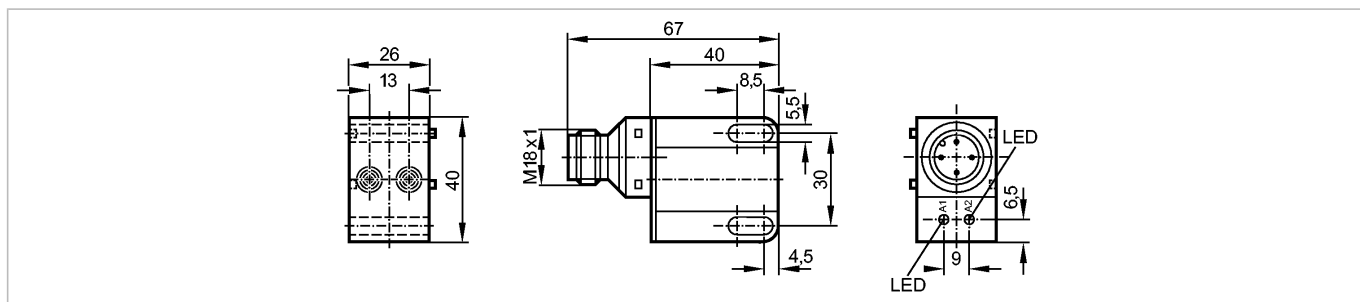

IN0108

IND2004DABOA/BS-200-K

Valve sensors

Product characteristics

Inductive sensor	
Rectangular, plastics	
Quick disconnect	
Sensing range 4 mm; [nf] non-flush mountable	

Electrical data

Electrical design		AC/DC
Operating voltage [V]		20...250 AC/DC
Protection class		II
Reverse polarity protection		yes

Outputs

Output function		2 x normally open
Voltage drop [V]		< 6.5
Minimum load current [mA]		5
Leakage current [mA]		< 2.5 (250 V AC) / < 1.3 (110 V AC) / < 0.8 (24 V DC)
Current rating		
- Current rating (continuous) [mA]		250 AC / 100 DC; 350 AC (...50 °C)
- Current rating (peak) [mA]		î: 2.2 A (20 ms / 0.5 Hz)
Short-circuit proof		no
Overload protection		no
Switching frequency [Hz]		25 AC / 50 DC

Monitoring range

Sensing range [mm]		4
Real sensing range (Sr) [mm]		4 ± 10 %
Operating distance [mm]		0...3.25

Accuracy / deviations

Correction factors		mild steel = 1 / stainless steel approx. 0.7 / brass approx. 0.4 / aluminium approx. 0.3 / copper approx. 0.2
Hysteresis [% of Sr]		1...15
Switch-point drift [% of Sr]		-10...10

Environment

Ambient temperature [°C]		-25...80
Protection		IP 67

Tests / approvals

EMC		EN 60947-5-2 EN 55011:	class B
MTTF [Years]			303

IN0108

IND2004DABOA/BS-200-K

Valve sensors

Mechanical data

Mounting	non-flush mountable
Housing materials	PBT
Weight [kg]	0.069

Displays / operating elements

Output status indication	LED	2 x yellow
--------------------------	-----	------------

Electrical connection

Connection	M18 connector
------------	---------------

Wiring

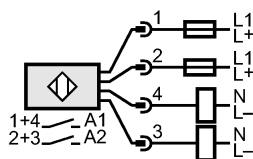

Note: miniature fuse to IEC60127-2 sheet 1, ≤ 2 A (fast acting)

Remarks

Remarks	Recommendation: check the unit for reliable function after a short circuit.
---------	---

Pack quantity [piece]	1
-----------------------	---