

**IIS210**

IHK3015BBPKG/M/US-104-DPS

Inductive sensors

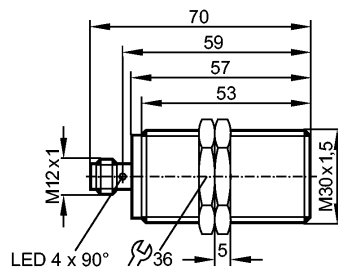

**Product characteristics**

Inductive sensor
Metal thread M30 x 1.5
Quick disconnect
Increased sensing range
gold-plated contacts
Sensing range 15 mm; [f] flush mountable

**Electrical data**

Electrical design	DC PNP
Operating voltage [V]	10...36 DC
Current consumption [mA]	< 10
Protection class	II
Reverse polarity protection	yes

**Outputs**

Output function	normally open
Voltage drop [V]	< 2.5
Current rating [mA]	100
Short-circuit protection	yes (non-latching)
Overload protection	yes
Switching frequency [Hz]	100

**Monitoring range**

Sensing range [mm]	15
Operating distance [mm]	0...12.1

**Accuracy / deviations**

Correction factors	mild steel = 1 / stainless steel approx. 0.7 / brass approx. 0.5 / aluminium approx. 0.5 / Cu approx. 0.4
Hysteresis [% of Sr]	1...20

**Environment**

Ambient temperature [°C]	-25...70
Protection	IP 67

**Tests / approvals**

EMC	EN 61000-4-2 ESD: 4 kV CD / 8 kV AD
	EN 61000-4-3 HF radiated: 10 V/m
	EN 61000-4-4 Burst: 2 kV
	EN 61000-4-5 Surge: 0.5 kV
	EN 61000-4-6 HF conducted: 10 V
	EN 55011: class B
MTTF [Years]	1590

**IIS210**

IIK3015BBPKG/M/US-104-DPS

**Inductive sensors**

**Mechanical data**

Mounting	flush mountable
Housing materials	stainless steel (316L); active face: PBT orange
Weight [kg]	0.133

**Displays / operating elements**

Output status indication	LED	yellow (4 x 90°)
--------------------------	-----	------------------

**Electrical connection**

Connection	M12 connector; gold-plated contacts
------------	-------------------------------------

**Wiring**

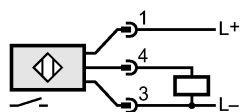

**Accessories**

Accessories (included)	2 lock nuts
------------------------	-------------

**Remarks**

Pack quantity	[piece]	1
---------------	---------	---