

no longer available - archive entry

**efector100**

IIM212



IIK3012BANKG/M/0.6M/ZH

Inductive sensors

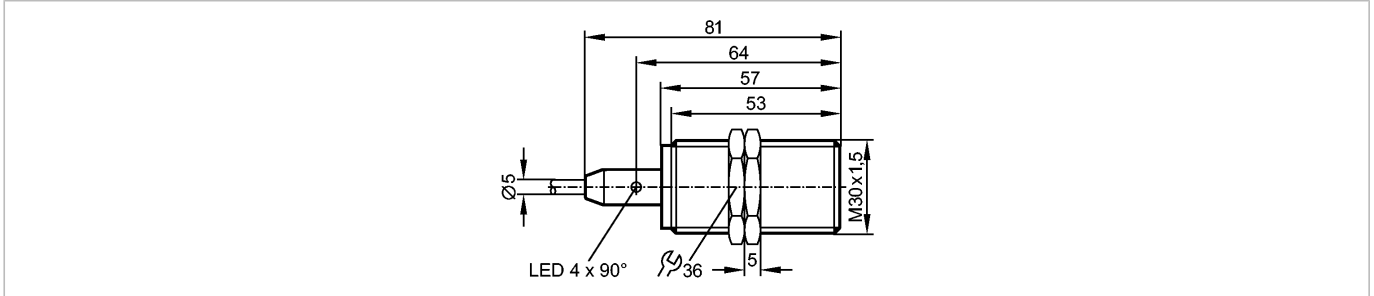

Product characteristics

Inductive sensor

Metal thread M30 x 1.5

Cable

Increased sensing range

Sensing range 12 mm; [f] flush mountable

Electrical data

Electrical design

DC NPN

Operating voltage [V]

10...36 DC

Current consumption [mA]

≤ 10

Protection class

II

Reverse polarity protection

yes

Outputs

Output function

normally open

Voltage drop [V]

≤ 2.5

Leakage current [mA]

< 0.1

Current rating [mA]

100

Short-circuit protection

yes (non-latching)

Overload protection

yes

Switching frequency [Hz]

100

Monitoring range

Sensing range [mm]

12

Operating distance [mm]

0...9.72

Accuracy / deviations

Correction factors

mild steel = 1 / stainless steel approx. 0.7 / brass approx. 0.5 / aluminium approx. 0.46 / Cu approx. 0.4

Hysteresis [% of Sr]

1...20

Environment

Ambient temperature [°C]

-40...85

Protection

IP 67 / IP 69K

Tests / approvals

EMC

EN 61000-4-2 ESD: 4 kV CD / 8 kV AD  
 EN 61000-4-3 HF radiated: 10 V/m (80...1000 MHz)  
 EN 61000-4-4 Burst: 2 kV  
 EN 61000-4-5 Surge: 0.5 kV  
 EN 61000-4-6 HF conducted: 10 V (0.15...80 MHz)  
 EN 55011: class B

MTTF [Years]

1052

Mechanical data

Mounting

flush mountable

Housing materials

housing: stainless steel; active face: PBT orange

Weight [kg]

0.17

# IIM212 - Inductive sensor - eclass: 27270101 / 27-27-01-01

Displays / operating elements

Output status indication LED | yellow (4 x 90°)

Electrical connection

Connection | PUR cable / 0.6 m

## Wiring

Core colors

BK black

BN brown

BU blue

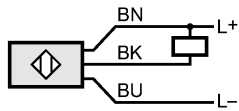

Accessories

Accessories (included) | 2 lock nuts

Remarks

Pack quantity [piece] | 1

ifm efector, inc. • 1100 Atwater Drive • Malvern • PA 19355 — We reserve the right to make technical alterations without prior notice. — US — IIM212 — 16.07.2004  
no longer available - archive entry