

no longer available - archive entry

efector100

I15746



IIB3015-BPKG/US-100-DPS RT

Inductive sensors

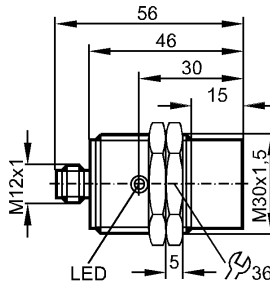

Product characteristics

Inductive sensor

Metal thread M30 x 1.5

Quick disconnect

Sensing range 15 mm; [nf] non-flush mountable

Electrical data

Electrical design

DC PNP

Operating voltage [V]

18...36 DC

Current consumption [mA]

15 (24 V)

Reverse polarity protection

yes

Outputs

Output function

normally open

Voltage drop [V]

< 2.5

Current rating [mA]

125; 150 (...50 °C)

Short-circuit protection

yes (non-latching)

Overload protection

yes

Switching frequency [Hz]

250

Monitoring range

Sensing range [mm]

15

Real sensing range (Sr) [mm]

15 ± 10 %

Operating distance [mm]

0...12.1

Accuracy / deviations

Correction factors

mild steel = 1 / stainless steel approx. 0.7 / brass approx. 0.4 / aluminium approx. 0.3 / copper approx. 0.2

Hysteresis [% of Sr]

1...15

Switch-point drift [% of Sr]

-10...10

Environment

Ambient temperature [°C]

-25...80

Protection

IP 67

Tests / approvals

EMC

EN 60947-5-2

EN 55011:

class B

Mechanical data

Mounting

non-flush mountable

Housing materials

brass nickel-plated; PBT

II5746 - Inductive sensor - eclass: 27270101 / 27-27-01-01

Weight	[kg]	0.129
Displays / operating elements		
Output status indication	LED	red
Electrical connection		
Connection		M12 connector

Wiring

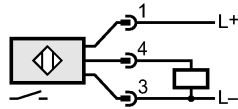

Accessories		
Accessories (included)		2 lock nuts
Remarks		
Pack quantity	[piece]	1

ifm efector, inc. • 1100 Atwater Drive • Malvern • PA 19355 — We reserve the right to make technical alterations without prior notice. — US — II5746 — 06.03.2003
no longer available - archive entry