

IGT200

IGB3012-BPKG/MV4A/US-104-DPS

Inductive sensors

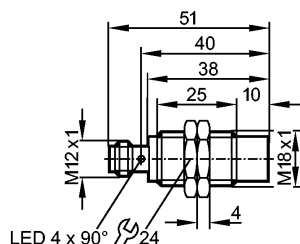

Product characteristics

Inductive sensor
Metal thread M18 x 1
Quick disconnect
Increased sensing range
gold-plated contacts
Sensing range 12 mm; [nf] non-flush mountable

Electrical data

Electrical design	DC PNP
Operating voltage [V]	10...36 DC
Current consumption [mA]	10 (24 V)
Protection class	II
Reverse polarity protection	yes

Outputs

Output function	normally open
Voltage drop [V]	< 2.5
Current rating [mA]	100
Short-circuit protection	yes (non-latching)
Overload protection	yes
Switching frequency [Hz]	300

Monitoring range

Sensing range [mm]	12
Real sensing range (Sr) [mm]	12 ± 10 %
Operating distance [mm]	0...9.7

Accuracy / deviations

Correction factors	mild steel = 1 / stainless steel approx. 0.7 / brass approx. 0.5 / aluminium approx. 0.4 / copper approx. 0.3
Hysteresis [% of Sr]	3...15
Switch-point drift [% of Sr]	-10...10

Environment

Ambient temperature [°C]	0...100
Protection	IP 68 / IP 69K; "COP"

Tests / approvals

EMC	EN 61000-4-2 ESD: 4 kV CD / 8 kV AD
	EN 61000-4-3 HF radiated: 10 V/m
	EN 61000-4-4 Burst: 2 kV
	EN 61000-4-6 HF conducted: 10 V
	EN 55011: class B

IGT200

IGB3012-BPKG/MV4A/US-104-DPS

Inductive sensors

MTTF	[Years]	1925
------	---------	------

Mechanical data

Mounting	non-flush mountable	
Housing materials	threaded sleeve: stainless steel (316L); active face: PEEK (polyether ether ketone)	
Weight	[kg]	0.045

Displays / operating elements

Output status indication	LED	yellow (4 x 90°)
--------------------------	-----	------------------

Electrical connection

Connection	M12 connector; gold-plated contacts	
------------	-------------------------------------	--

Wiring

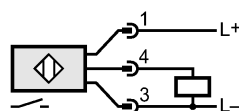

Accessories

Accessories (included)	2 lock nuts	
------------------------	-------------	--

Remarks

Pack quantity	[piece]	1
---------------	---------	---