

IF5653

IFA4002-CPKG/US-104-DPA

Inductive sensors

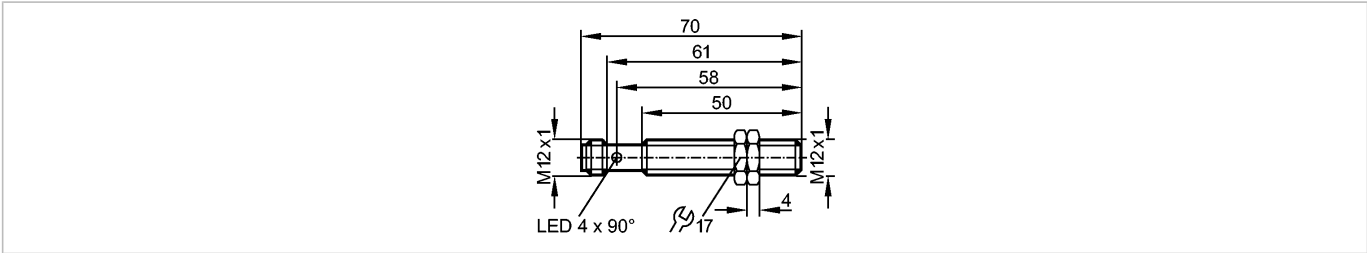

Product characteristics

Inductive sensor
Metal thread M12 x 1
Quick disconnect
Sensing range 2 mm; [f] flush mountable

Electrical data

Electrical design	DC PNP
Operating voltage [V]	10...36 DC
Current consumption [mA]	15 (24 V)
Protection class	II
Reverse polarity protection	yes

Outputs

Output function	complementary
Voltage drop [V]	< 3.5

Current rating

- Current rating (continuous) [mA]	250; 400 (...50 °C)
- Current rating (peak) [mA]	400
Short-circuit protection	yes (non-latching)
Overload protection	yes
Switching frequency [Hz]	1200

Monitoring range

Sensing range [mm]	2
Real sensing range (Sr) [mm]	2 ± 10 %
Operating distance [mm]	0...1.6

Accuracy / deviations

Correction factors	mild steel = 1 / stainless steel approx. 0.7 / brass approx. 0.5 / aluminium approx. 0.4 / copper approx. 0.3
Hysteresis [% of Sr]	1...15
Switch-point drift [% of Sr]	-10...10

Environment

Ambient temperature [°C]	-25...80
Protection	IP 65

Tests / approvals

EMC	EN 60947-5-2 EN 55011: class B
MTTF [Years]	1865

Mechanical data

Mounting	flush mountable
----------	-----------------

IF5653

IFA4002-CPKG/US-104-DPA

Inductive sensors

Housing materials	brass white bronze coated; active face: PC (polycarbonate)
-------------------	--

Weight	[kg]	0.03
--------	------	------

Displays / operating elements

Output status indication	LED	yellow (4 x 90°)
--------------------------	-----	------------------

Electrical connection

Connection	M12 connector
------------	---------------

Wiring

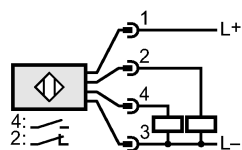

Accessories

Accessories (included)	2 lock nuts
------------------------	-------------

Remarks

Pack quantity	[piece]	1
---------------	---------	---