

no longer available - archive entry Alternative article: IF5813 + EVT064

When selecting an alternative article and accessories please note that technical data may differ!

efectorio

IF5217



IFK3004-BPOG/V4A

Inductive sensors

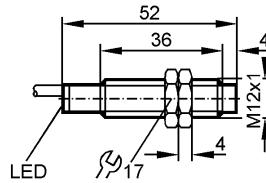

Product characteristics

Inductive sensor

Metal thread M12 x 1

Cable

Sensing range 4 mm; [nf] non-flush mountable

Electrical data

Electrical design

DC PNP

Operating voltage [V]

10...30 DC

Current consumption [mA]

15 (24 V)

Protection class

II

Reverse polarity protection

no

Outputs

Output function

normally open

Voltage drop [V]

< 1

Current rating [mA]

200

Short-circuit protection

no

Overload protection

no

Switching frequency [Hz]

1000

Monitoring range

Sensing range [mm]

4

Real sensing range (Sr) [mm]

4 ± 10 %

Operating distance [mm]

0...3.25

Accuracy / deviations

Correction factors

mild steel = 1 / stainless steel approx. 0.7 / brass approx. 0.4 / aluminium approx. 0.3 / copper approx. 0.2

Hysteresis [% of Sr]

3...15

Switch-point drift [% of Sr]

-10...10

Environment

Ambient temperature [°C]

-25...80

Protection

IP 67

Tests / approvals

EMC

EN 60947-5-2

MTTF [Years]

4292

Mechanical data

Mounting

non-flush mountable

Housing materials

stainless steel 316Ti / 1.4571 nickel-plated; PBT

IF5217 - Inductive sensor - eclass: 27270101 / 27-27-01-01

Weight	[kg]	0.058
Displays / operating elements		
Output status indication	LED	yellow
Electrical connection		
Connection		PVC cable / 2 m; 3 x 0.14 mm ²

Wiring

Core colors

BK black
BN brown
BU blue

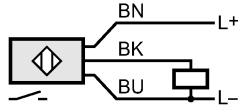

Accessories		
Accessories (included)		2 lock nuts
Remarks		
Pack quantity	[piece]	1

ifm efector, inc. • 1100 Atwater Drive • Malvern • PA 19355 — We reserve the right to make technical alterations without prior notice. — US — IF5217 — 06.03.2003

no longer available - archive entry Alternative article: IF5813 + EVT064

When selecting an alternative article and accessories please note that technical data may differ!