

**E60067**

COUPLING 25-10-10-32-KV

Accessories

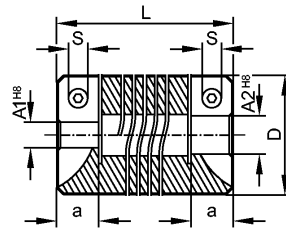

**Product characteristics**

Flexible coupling with clamp connection [KV]

Ø 10 mm / Ø 10 mm

**Mechanical data**

|   |  |
|---|--|
| Dimension [mm]                          | D: 25<br>A1: 10<br>A2: 10<br>L: 32<br>a: 8<br>S: M3  |
| Max. permissible rpm [1/min]            | 6000   |
| Max. torque [Ncm]                       | 120  |
| Max. torque clamping screws [Ncm]       | 100  |
| Rigidity of the torsion spring [Nm/rad] | 16   |
| Displacement                            | max. radial displacement: ± 0.35 mm<br>max. angular displacement: ± 4.0 °<br>max. axial displacement: ± 0.5 mm |
| Housing materials                       | aluminum   |
| Weight [kg]                             | 0.033  |

**Remarks**

Remarks

The data indicated apply to couplings with the above hub borings at an ambient temperature of 23 °C.  
The values of radial, angular and axial displacement are maximum values which must not reach their maximum simultaneously while in operation.

Pack quantity [piece] 1