

COUPLING 25-6-10-32-KV

Accessories

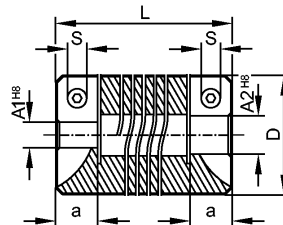

Product characteristics

Flexible coupling with clamp connection [KV]

Ø 6 mm / Ø 10 mm

Mechanical data

Dimension [mm]

D: 25  
A1: 6  
A2: 10  
L: 32  
a: 8  
S: M3

Max. permissible rpm [1/min]

6000

Max. torque [Ncm]

120

Max. torque clamping screws [Ncm]

100

Rigidity of the torsion spring [Nm/rad]

16

Displacement

max. radial displacement: ± 0.35 mm  
max. angular displacement: ± 4.0 °  
max. axial displacement: ± 0.5 mm

Housing materials

aluminum

Weight [kg]

0.035

Remarks

Remarks

The data indicated apply to couplings with the above hub borings at an ambient temperature of 23 °C.  
The values of radial, angular and axial displacement are maximum values which must not reach their maximum simultaneously while in operation.

Pack quantity [piece]

1