

COUPLING 19.2-6-6-22-SV

Accessories

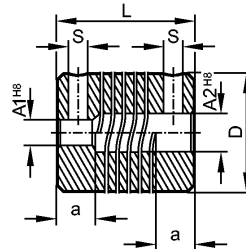

Product characteristics

Flexible coupling with adjusting screw connection [SV]

Ø 6 mm / Ø 6 mm

Mechanical data

Dimension [mm]

D: 19  
A1: 6  
A2: 6  
L: 22  
a: 6  
S: M3

Max. permissible rpm [1/min]

8000

Max. torque [Ncm]

60

Max. torque clamping screws [Ncm]

50

Rigidity of the torsion spring [Nm/rad]

9

Displacement

max. radial displacement: ± 0.25 mm  
max. angular displacement: ± 3.5 °  
max. axial displacement: ± 0.4 mm

Housing materials

aluminum

Weight

[kg]

0.015

Remarks

Remarks

The data indicated apply to couplings with the above hub borings at an ambient temperature of 23 °C.  
The values of radial, angular and axial displacement are maximum values which must not reach their maximum simultaneously while in operation.

Pack quantity

[piece]

1