

COUPLING 25-10-10-24-SV

Accessories

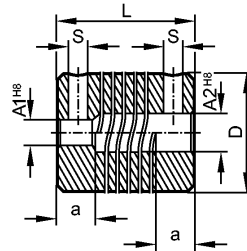

Product characteristics

Flexible coupling with adjusting screw connection [SV]

Ø 10 mm / Ø 10 mm

Mechanical data

Dimension [mm]

D: 25

A1: 10

A2: 10

L: 24

a: 7

S: M4

Max. permissible rpm [1/min]

8000

Max. torque [Ncm]

100

Max. torque clamping screws [Ncm]

120

Rigidity of the torsion spring [Nm/rad]

20

Displacement

max. radial displacement: ± 0.3 mm

max. angular displacement: ± 4.0 °

max. axial displacement: ± 0.5 mm

Housing materials

aluminum

Weight [kg]

0.026

Remarks

Remarks

The data indicated apply to couplings with the above hub borings at an ambient temperature of 23 °C.

The values of radial, angular and axial displacement are maximum values which must not reach their maximum simultaneously while in operation.

Pack quantity [piece]

1