

WELDING ADAPT G1 ST52-3

Accessories

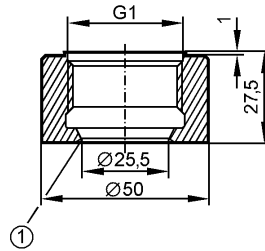

1: Sealing edge

Product characteristics

Welding adapter

G 1 - Ø 50 mm

Environment

Pressure rating [bar]

50; for the connection sensor - adapter

Mechanical data

Housing materials

steel (1.0570)

Surface characteristics Ra / Rz of the wetted part(s)

0.4 / 4

Weight [kg]

0.289

Remarks

Pack quantity [piece]

1