

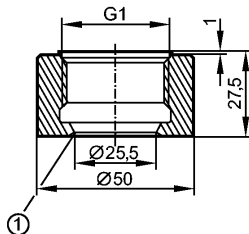

WELDING ADAPT G1 V4A

Accessories



1: Sealing edge

**EC 1935/2004 EHEDG Certified FDA**

Product characteristics

Welding adapter

G 1 - Ø 50 mm

Environment

Pressure rating [bar] 150; for the connection sensor - adapter

Mechanical data

Process connection

Welding adapter D50

for units with process connection

G 1

Sealing

Metal to metal seal

Housing materials

stainless steel 316L / 1.4404

Surface characteristics Ra / Rz of the wetted part(s)

0.4 / 4

Weight

[kg]

0.291

Remarks

Pack quantity

[piece]

1