

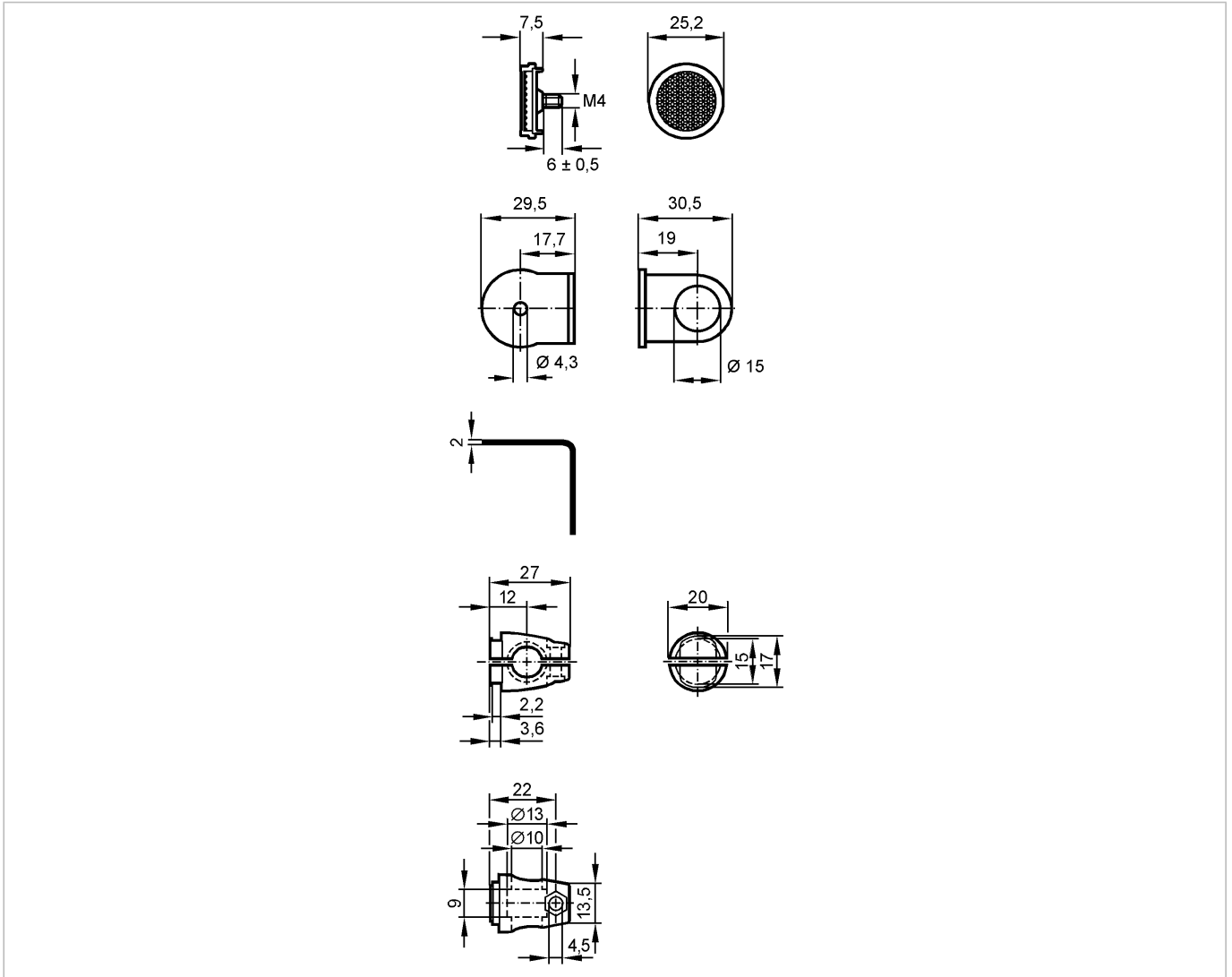

SYSTEM COMPONENT REFLECTOR

Accessories



Product characteristics

Mounting set

Clamp mounting

Mechanical data

Design

for reflector

Housing materials

fixture: stainless steel 316Ti / 1.4571; clamp: diecast zinc

Type of mounting

free-standing M8

Weight

[kg]

0.093

Accessories

Accessories (included)

screw; M8 x 40

Remarks

Pack quantity

[piece]

1