

SYSTEM COMPONENT M18 BOLT

Accessories

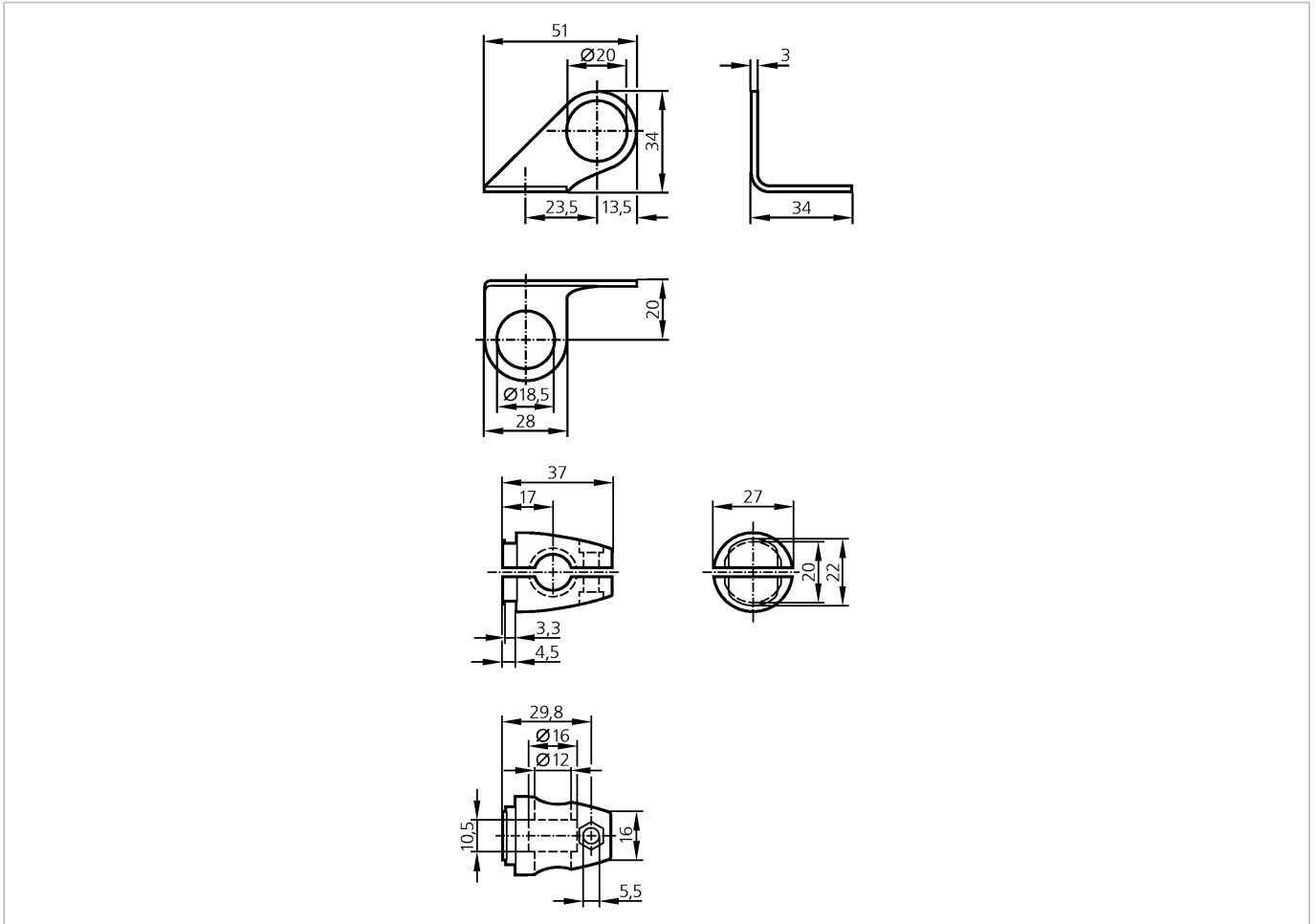

Product characteristics

Mounting set

$\varnothing 18.5$ mm

Clamp mounting

Mechanical data

Design

for types OG, IG, KG

Housing materials

fixture: stainless steel 316Ti / 1.4571; clamp: stainless steel (316C)

Type of mounting

free-standing M10

Weight

[kg]

0.186

Accessories

Accessories (included)

Head cap screw; M10 x 55

Remarks

Pack quantity

[piece]

1