

no longer available - archive entry Alternative article: OPU201

When selecting an alternative article and accessories please note that technical data may differ!

efector200

E20689



FE-11-EPX-X/F2X1/2M

Fiber optics

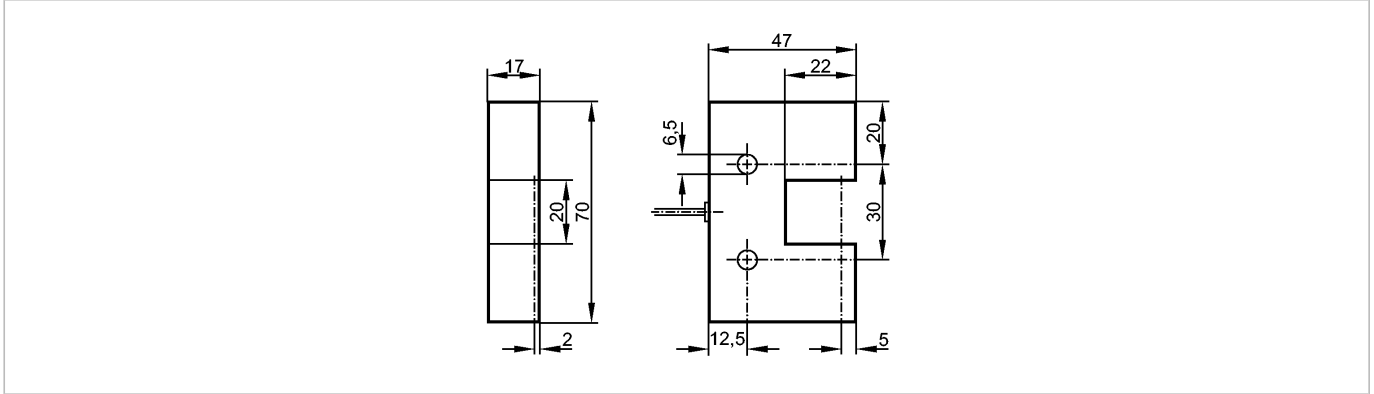

Product characteristics

Through-beam sensor

17 x 70 x 47

Amplifier Sensing range

OB50xx 20 mm

OBFxxx 20 mm

OO50xx 20 mm

Monitoring range

Sensing range

OB50xx: 20 mm / OBFxxx: 20 mm / OO50xx: 20 mm

Environment

Ambient temperature [°C]

-25...60

Mechanical data

Length [mm]

2000

Min. bending radius [mm]

30

Fiber arrangement



core diameter [mm]

1 mm

Fiber optic

PMMA

Sensing head

PA

Sheathing

PE (polyethylene)

Weight [kg]

0.108

Accessories

Accessories (optional)

cutter E20600 for fibre optics (to be ordered separately)

Remarks

Pack quantity [piece]

1

ifm efector, inc. • 1100 Atwater Drive • Malvern • PA 19355 — We reserve the right to make technical alterations without prior notice. — US — E20689 — 06.03.2003

no longer available - archive entry Alternative article: OPU201

When selecting an alternative article and accessories please note that technical data may differ!