

no longer available - archive entry

efector200

E20235



FE-00-P-A-R3/1.5M

Fiber optics

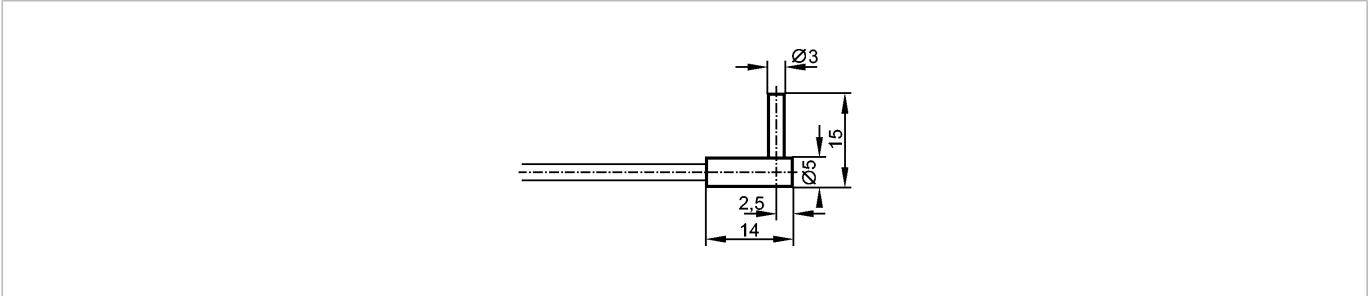

Product characteristics

Through-beam sensor

Sensing range 108 mm

Connection to fibre optic amplifiers type OKF / OUF

Monitoring range

Sensing range OKF: 108 mm / OUF: 108 mm

Environment

Ambient temperature [°C] -20...80

Mechanical data

Design angled

Length [mm] 1500

Min. bending radius [mm] 10

Fiber optic glass

Sensing head aluminum

Sheathing PVC; adapter: PPO

Weight [kg] 0.083

Accessories

Accessories (included) E20104

Remarks

Pack quantity [piece] 1

ifm efector, inc. • 1100 Atwater Drive • Malvern • PA 19355 — We reserve the right to make technical alterations without prior notice. — US — E20235 — 04.06.2003

no longer available - archive entry