

E11913

ADAPT TIE ROD CYL D3-6

Accessories

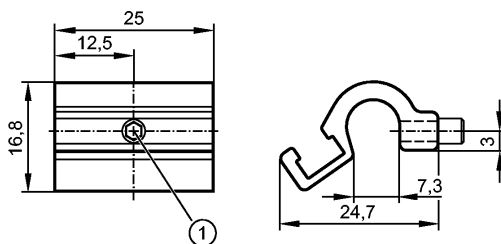

1: fixing screw across flats 2

Product characteristics

Adapter for tie rod cylinders
(or cylinders of the same dimensions)

Mechanical data

Design	for types MKT (T-slot cylinder sensors)
Housing materials	aluminum; screw: stainless steel
Rod Diameter [mm]	3...7
Weight [kg]	0.01

Accessories

Accessories (included)	1 screw
------------------------	---------

Remarks

Pack quantity [piece]	1
-----------------------	---