

**E11890**

ADAPT FOR CYL SMC ECDQ2

**Accessories**

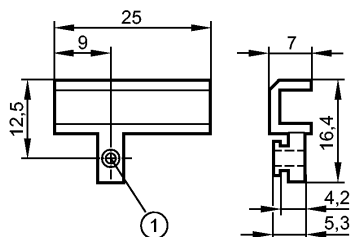

1: fixing screw across flats 1.5

**Product characteristics**

Adapter for SMC cylinders ECDQ2 series  
(or cylinders of the same dimensions)

T-slot rail, flat

**Mechanical data**

Design	for types MKT (T-slot cylinder sensors)
Housing materials	aluminum; screw: stainless steel
Weight [kg]	0.004

**Remarks**

Pack quantity [piece]	1
-----------------------	---