

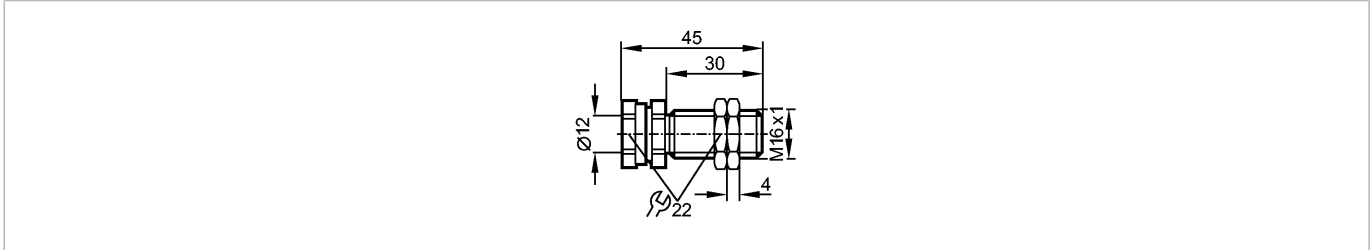

Fixing/M12/basic/MS/end stop

Accessories



Product characteristics

Mounting sleeve

M16 x 1 - Ø 12 mm

45 mm

Mechanical data

Design

with end stop for types M12

Housing materials

brass nickel-plated

Weight

[kg]

0.055

Mounting instruction

Align the sensing face of the sensor to the right (see scale drawing)

Accessories

Accessories (included)

2 nuts; nickel-plated brass

Remarks

Pack quantity

[piece]

1