

no longer available - archive entry replaced by: ENC04A

ecomat 400

E10355



ADOAH040MSN0002A04

Connection technology

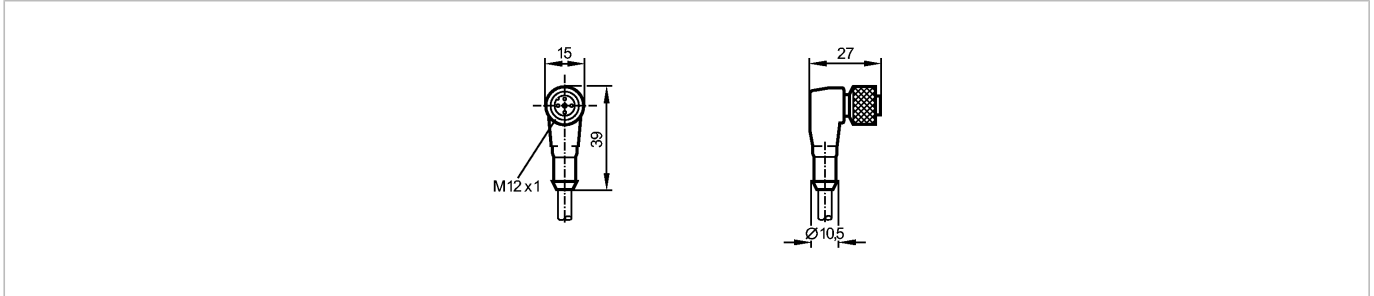

Product characteristics

Socket

For sensors with

M12 connector

Application: Ex zone 1

Electrical data

Electrical design

DC

Operating voltage [V]

...15 DC

Environment

Ambient temperature [°C]

-25...90

Protection

IP 67

Safety classification

Internal capacitance [nF]

0.196

Internal inductance [µH]

4

Mechanical data

Design

angled

Material body

TPU (urethane)

Material nut

brass; nickel-plated

Tightening torque for knurled nut [Nm]

0.5

Weight [kg]

0.085

Electrical connection

Connection

PUR / PVC cable / 2 m;
4 x 0.34 mm² (42 x Ø 0.1 mm); Ø 5 mm

Sheath color

blue

Wiring

Core colors

BK black

BN brown

BU blue

WH white

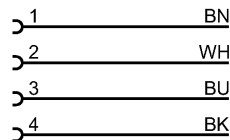

Remarks

Remarks

When using sockets in explosion-protected areas (ATEX) there are special requirements regarding wiring.

The requirements of the applicable installation regulations must absolutely be adhered to by the user on his own responsibility.

Pack quantity

[piece]

1

ifm efector, inc. • 1100 Atwater Drive • Malvern • PA 19355 — We reserve the right to make technical alterations without prior notice. — US — E10355 — 18.06.2009

no longer available - archive entry replaced by: ENC04A