

no longer available - archive entry replaced by: DW2503
 Article available until 31 March 2014

ecomat200[®]
 DW2004



MONITOR/FA-1 / 24VDC

Evaluation systems, power supplies

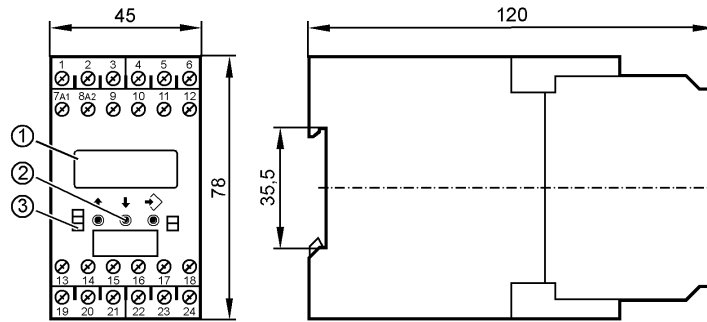

- 1: LCD display; 7/14-segment
- 2: Programming buttons
- 3: LEDs



Product characteristics
 MONITOR

FA-1

Housing for DIN rail mounting

programmable

Analog output

0/4...20 mA; 0...10 V

proportional / antiproportional

averaging

Teach function

integrated pulse monitoring

Key function

1 relay output

1 transistor output

Application

Application

Conversion of pulse sequences into analogue standard signals

Electrical data

Nominal voltage [V]

27 DC (typ. 24 DC)

Voltage tolerance [%]

-20...+10

Power consumption [VA]

4

Inputs

Inputs

pnp/npn; NAMUR (24 V)

auxiliary supply: typ. 24 V DC / 15 mA; short-circuit protected

threshold pnp: > 12 V on; < 5 V off

threshold npn: > 15 V off; < 8 V on

input frequency (max): 15 kHz (corresponds to min. pulse length / space 33 μs)

Outputs

Relay

Relay outputs

1 changeover contact, floating

switching capacity: 6 A (250 V AC); B300, R300

Transistor

Transistor outputs

1 x pnp; external supply

switching voltage/current: 24 V DC / max. 15 mA; short-circuit protected

analog

DW2004 - MONITOR - eclass: 27279213 / 27-27-92-13

| | |
|-----------------------------------|--|
| Analog outputs | voltage: 0...10 V (max. 10.25 V), load min. 10 kΩ current: 0/4...20 mA (max. 20.5 mA), load max. 500 Ω |
| Characteristics | transmission accuracy: ± 0.2 % (of the analogue final value) resolution (internal): 12 bits temperature drift: < ± 100 ppm/K |
| Measuring / setting range | |
| Setting range [pulses/min.] | 0...600000 (0.0...10000 Hz) |
| Environment | |
| Ambient temperature [°C] | -20...60 |
| Storage temperature [°C] | -25...80 |
| Max. relative air humidity [%] | 75 (35°C) |
| Protection housing / terminals | IP 50 / IP 20 |
| Tests / approvals | |
| EMC | EN 61010: 1993 + A2: 1995 EMC 89/336/EEC EN 50081-1 EN 61000-6-2 |
| Mechanical data | |
| Housing materials | plastics |
| Weight [kg] | 0.299 |
| Displays / operating elements | |
| Input pulses LED | yellow |
| Output status indication LED | green (lights when the relay is energised / the transistor is closed) |
| Function display LED | LCD display; 7/14-segment |
| Electrical connection | |
| Connection | dual-chamber terminals 2 x 2.5 mm ² (2 x AWG 14) |
| Wiring | |
| 1: DC Supply voltage (L-) | |
| 2: DC Supply voltage (L+) | |
| 3: supply transistor outputs (L+) | |
| 4: sensor signal pnp | |
| 5: DC Sensor supply (L+) | |
| 6: DC Sensor supply (L-) | |
| 7: n.c. | |
| 8: n.c. | |
| 9: n.c. | |
| 10: sensor signal npn | |
| 11: Reset pnp | |
| 12: transistor output pnp | |
| 13: Relay (common) | |
| 14: Relay (normally open) | |
| 15: Relay (normally closed) | |
| 16: n.c. | |
| 17: n.c. | |
| 18: n.c. | |
| 19: n.c. | |
| 20: n.c. | |
| 21: n.c. | |
| 22: analog output (mA) | |
| 23: analog output (GND) | |
| 24: analog output (V) | |
| Remarks | |
| Remarks | overvoltage category II; degree of soiling 2 |
| Pack quantity [piece] | 1 |