

no longer available - archive entry replaced by: DW2503  
 Article available until 31 March 2014

**ecomat200**<sup>®</sup>  
 DW2003



MONITOR/FA-1 /100-240VAC/DC

Evaluation systems, power supplies

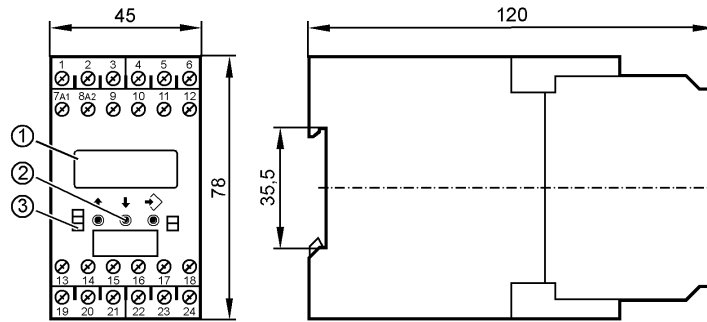

- 1: LCD display; 7/14-segment
- 2: Programming buttons
- 3: LEDs



Product characteristics  
 MONITOR

FA-1	
Housing for DIN rail mounting	
programmable	
Analog output	
0/4...20 mA; 0...10 V	
proportional / antiproportional	
averaging	
Teach function	
integrated pulse monitoring	
Key function	
1 relay output	
1 transistor output	
Application	
Application	Conversion of pulse sequences into analogue standard signals
Electrical data	
Nominal voltage [V]	110...240 AC (50...60 Hz) / 27 DC (typ. 24 DC)
Voltage tolerance [%]	-20...+10
Power consumption [VA]	5
Inputs	
Inputs	<p>pnp/npn; NAMUR (24 V)          auxiliary supply: typ. 24 V DC / 150 mA; short-circuit protected          threshold pnp: &gt; 12 V on; &lt; 5 V off          threshold npn: &gt; 15 V off; &lt; 8 V on          input frequency (max): 15 kHz (corresponds to min. pulse length / space 33 μs)</p>
Outputs	
Relay	
Relay outputs	<p>1 changeover contact, floating          switching capacity: 6 A (250 V AC); B300, R300</p>
Transistor	
Transistor outputs	<p>1 x pnp; external supply          switching voltage/current: 24 V DC / max. 15 mA; short-circuit protected</p>
analog	

**DW2003 - MONITOR - eclass: 27279213 / 27-27-92-13**

Analog outputs	voltage: 0...10 V (max. 10.25 V), load min. 10 kΩ current: 0/4...20 mA (max. 20.5 mA), load max. 500 Ω
Characteristics	transmission accuracy: ± 0.2 % (of the analogue final value) resolution (internal): 12 bits temperature drift: < ± 100 ppm/K
Measuring / setting range	
Setting range [pulses/min.]	0...600000 (0.0...10000 Hz)
Environment	
Ambient temperature [°C]	-20...60
Storage temperature [°C]	-25...80
Max. relative air humidity [%]	75 (35°C)
Protection housing / terminals	IP 50 / IP 20
Tests / approvals	
EMC	EN 61010: 1993 + A2: 1995 EMC 89/336/EEC EN 50081-1 EN 61000-6-2
Mechanical data	
Housing materials	plastics
Weight [kg]	0.346
Displays / operating elements	
Input pulses LED	yellow
Output status indication LED	green (lights when the relay is energised / the transistor is closed)
Function display LED	LCD display; 7/14-segment
Electrical connection	
Connection	dual-chamber terminals 2 x 2.5 mm <sup>2</sup> (2 x AWG 14)
<b>Wiring</b>	
1: 24 V DC Supply voltage (L-)	
2: 24 V DC Supply voltage (L+)	
3: supply transistor outputs (L+)	
4: sensor signal pnp	
5: DC Sensor supply (L+)	
6: DC Sensor supply (L-)	
7: AC Supply voltage (L1)	
8: AC Supply voltage (N)	
9: n.c.	
10: sensor signal npn	
11: Reset pnp	
12: transistor output pnp	
13: Relay (common)	
14: Relay (normally open)	
15: Relay (normally closed)	
16: n.c.	
17: n.c.	
18: n.c.	
19: n.c.	
20: n.c.	
21: n.c.	
22: analog output (mA)	
23: analog output (GND)	
24: analog output (V)	
Remarks	
Remarks	overvoltage category II; degree of soiling 2
Pack quantity [piece]	1