

no longer available - archive entry replaced by: DS2605
 Article available until 31 March 2014

ecomat200[®]
 DS2105



MONITOR/FS-2N/110-240VAC/DC

Evaluation systems, power supplies

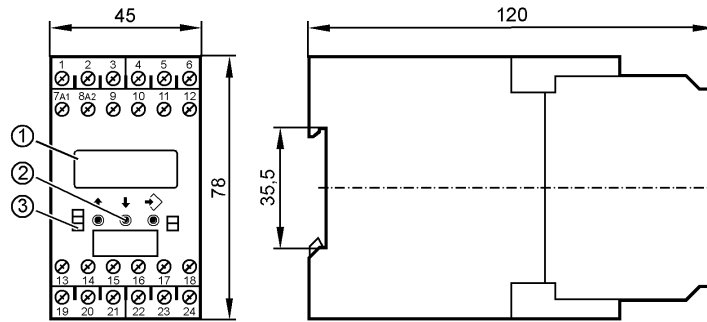

- 1: LCD display; 7/14-segment
- 2: Programming buttons
- 3: LEDs



Product characteristics

MONITOR	
FS-2N	
Pulse difference monitor	
Housing for DIN rail mounting	
NAMUR inputs with wire monitoring	
2 relay outputs	
2 transistor outputs	
programmable	
Adjustable reset time	
Key function	
Application	
Application	pulse evaluation system with microprocessor for slip/synchronous monitoring; evaluation of pulse differences
Switching function	2 switch points for slip/synchronous monitoring
Electrical data	
Nominal voltage [V]	110...240 AC (50...60 Hz) / 27 DC (typ. 24 DC)
Voltage tolerance [%]	-20...+10
Power consumption [VA]	5 (3 W)
Inputs	
Inputs	NAMUR (EN 50227) auxiliary supply: typ. 8.2 V DC; short-circuit protected wire monitoring: < 0.1 mA / > 6.0 mA counting frequency (max): 400 Hz (pulse length > 1.2 ms)
Outputs	
Relay	
Contact rating	6 A (250 V AC); B300, R300
Transistor	
Transistor outputs	pnp; external supply switching voltage/current: 24 V DC / max. 15 mA; short-circuit protected
Measuring / setting range	
Setting range	1...60000 (0.1...1000 Hz)
Adjustment range	pulse differences: 1...999 reset pulses: 0.0...1000.0 s

DS2105 - MONITOR - eclass: 27279213 / 27-27-92-13

Accuracy / deviations	
Measuring error [% of the final value]	< 1
Environment	
Ambient temperature [°C]	-20...60
Storage temperature [°C]	-25...80
Max. relative air humidity [%]	75 (35°C)
Protection housing / terminals	IP 50 / IP 20
Tests / approvals	
EMC	EN 61010: 1993 + A2: 1995 EMC 89/336/EEC EN 50081-1 EN 61000-6-2
Mechanical data	
Housing materials	plastics
Weight [kg]	0.345
Displays / operating elements	
Input pulses LED	yellow (input pulses); red (wire fault)
Output status indication LED	green (lights when the relay is energised / the transistor is closed)
Display	LCD display; 7/14-segment
Electrical connection	
Connection	dual-chamber terminals 2 x 2.5 mm ² (2 x AWG 14)
Wiring	
1: DC Supply voltage (L-) 2: DC Supply voltage (L+) 3: supply transistor outputs (L+) 4: error output 1 5: 8.2 V DC Sensor supply 1 (L-) 6: 8.2 V DC Sensor supply 1 (L+) 7: AC Supply voltage (L1) 8: AC Supply voltage (N) 9: n.c. 10: error output 2 11: 8.2 V DC Sensor supply 2 (L-) 12: 8.2 V DC Sensor supply 2 (L+) 13: Relay 1 (common) 14: Relay 1 (normally open) 15: Relay 1 (normally closed) 16: stepping output 1 17: release 1/2 pnp 18: Reset 1/2 pnp 19: Relay 2 (common) 20: Relay 2 (normally open) 21: Relay 2 (normally closed) 22: n.c. 23: n.c. 24: stepping output 2	
Remarks	
Remarks	overvoltage category II; degree of soiling 2
Pack quantity [piece]	1

ifm efector, inc. • 1100 Atwater Drive • Malvern • PA 19355 — We reserve the right to make technical alterations without prior notice. — US — DS2105 — 06.12.2012

no longer available - archive entry replaced by: DS2605

Article available until 31 March 2014