

no longer available - archive entry replaced by: DS2503  
 Article available until 31 March 2014

**ecomat200**<sup>®</sup>  
 DS2003



MONITOR/FS-1 /110-240VAC/DC

Evaluation systems, power supplies

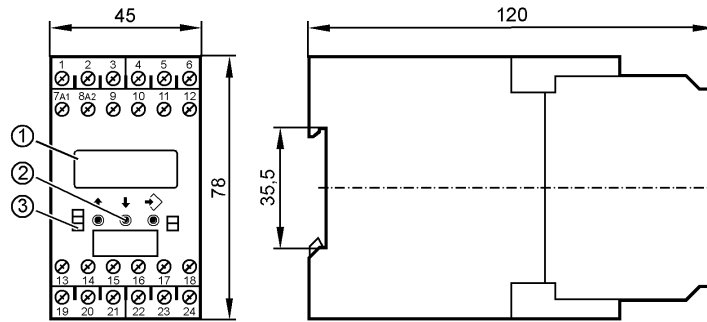

- 1: LCD display; 7/14-segment
- 2: Programming buttons
- 3: LEDs



Product characteristics  
 MONITOR

FS-1

Housing for DIN rail mounting

2 relay outputs

2 transistor outputs

programmable

Test function without external frequency

Key function

Application

Application

pulse evaluation system with  $\mu$ processor for slip/synchronous monitoring as well as frequency; rotational speed and speed

Switching function

1 switching output for slip monitoring; 1 switching output for overspeed/underspeed and acceptable range

Electrical data

Nominal voltage [V]

110...240 AC (50...60 Hz) / 27 DC (typ. 24 DC)

Voltage tolerance [%]

-20...+10

Power consumption [VA]

5 (3 W)

Inputs

Inputs

pnp/npn; NAMUR (24 V)  
 auxiliary supply: typ. 24 V DC / 15 mA; short-circuit protected  
 threshold pnp: > 12 V on; < 5 V off  
 threshold npn: > 15 V off; < 8 V on  
 input frequency (max): 5 kHz (min. pulse length 0.1 ms)

Outputs

Relay

Contact rating

6 A (250 V AC); B300, R300

Transistor

Transistor outputs

pnp; external supply  
 switching voltage/current: 24 V DC / max. 15 mA; short-circuit protected

Measuring / setting range

Setting range

1...60000 (0.1...1000 Hz)

Adjustment range

slip: 0.1...99.9 %  
 rotational speed (frequency): 1...60000 pulses/min (0.1...1000 Hz)

**DS2003 - MONITOR - eclass: 27279213 / 27-27-92-13**

Accuracy / deviations	
Measuring error [% of the final value]	< 1
Environment	
Ambient temperature [°C]	-20...60
Storage temperature [°C]	-25...80
Max. relative air humidity [%]	75 (35°C)
Protection housing / terminals	IP 50 / IP 20
Tests / approvals	
EMC	EN 61010: 1993 + A2: 1995 EMC 89/336/EEC EN 50081-1 EN 61000-6-2
Mechanical data	
Housing materials	plastics
Weight [kg]	0.349
Displays / operating elements	
Display	LC display 7/14-segment LED green lights when the relay is energised / the Switching status transistor is closed Input pulses LED green
Electrical connection	
Connection	dual-chamber terminals 2 x 2.5 mm <sup>2</sup> (2 x AWG 14)
<b>Wiring</b>	
1: DC Supply voltage (L-) 2: DC Supply voltage (L+) 3: supply transistor outputs (L+) 4: sensor signal 1 pnp 5: DC Sensor supply (L+) 6: DC Sensor supply (L-) 7: AC Supply voltage (L1) 8: AC Supply voltage (N) 9: n.c. 10: sensor signal 1 npn 11: sensor signal 2 pnp 12: sensor signal 2 npn 13: Relay 1 (common) 14: Relay 1 (normally open) 15: Relay 1 (normally closed) 16: transistor output 1 pnp 17: Reset 1 pnp 18: Reset 2 pnp 19: Relay 2 (common) 20: Relay 2 (normally open) 21: Relay 2 (normally closed) 22: n.c. 23: n.c. 24: transistor output 2 pnp	
Remarks	
Remarks	overvoltage category II; degree of soiling 2
Pack quantity [piece]	1

ifm efector, inc. • 1100 Atwater Drive • Malvern • PA 19355 — We reserve the right to make technical alterations without prior notice. — US — DS2003 — 06.12.2012

no longer available - archive entry replaced by: DS2503

Article available until 31 March 2014