

no longer available - archive entry replaced by: DD2603  
 Article available until 31 March 2014

**ecomat200**  
 DD2104



MONITOR/FR-1N/ 23-60VAC/DC

Evaluation systems, power supplies

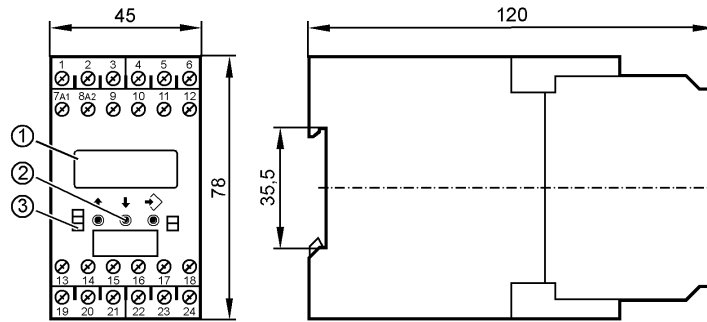

- 1: LCD display; 7/14-segment
- 2: Programming buttons
- 3: LEDs



Product characteristics

MONITOR	
FR-1N	
Housing for DIN rail mounting	
NAMUR input with wire monitoring	
2 relay outputs	
2 transistor outputs	
Analog output	
0/4...20 mA	
programmable	
Test function without external frequency	
Key function	
Application	
Application	single pulse evaluation system with $\mu$ processor for frequency; rotational speed; speed and machine cycles
Switching function	2 switch points for monitoring overspeed/underspeed and acceptable range
Electrical data	
Nominal voltage [V]	23...60 AC/DC (50...60 Hz) / 27 DC (typ. 24 DC)
Voltage tolerance [%]	-20...+10
Power consumption [VA]	5 (3 W)
Inputs	
Inputs	NAMUR (EN 50227) auxiliary supply: typ. 8.2 V DC; short-circuit protected wire monitoring: < 0.1 mA / > 6.0 mA input frequency (max): 5 kHz (corresponds to min. pulse length / space 0.1 ms)
Outputs	
Relay	
Contact rating	6 A (250 V AC); B300, R300
Transistor	
Transistor outputs	pnp; external supply switching voltage/current: 24 V DC / max. 15 mA; short-circuit protected
analog	
Analog output	0/4...20 mA
Max. load [ $\Omega$ ]	500

**DD2104 - MONITOR - eclass: 27279213 / 27-27-92-13**

	limitation: 20.5 mA; accuracy: 1 % (of the final value)
Measuring / setting range	
Setting range [pulses/min.]	1...60000 (0.1...1000 Hz)
Accuracy / deviations	
Measuring error [% of the final value]	< 1
Environment	
Ambient temperature [°C]	-20...60
Storage temperature [°C]	-25...80
Max. relative air humidity [%]	75 (35°C)
Protection housing / terminals	IP 50 / IP 20
Tests / approvals	
EMC	EN 61010 : 2001 EMC 89/336/EEC EN 61000-6-3 : 2007 EN 61000-6-2 : 2005
Mechanical data	
Housing materials	plastics
Weight [kg]	0.38
Displays / operating elements	
Input pulses LED	yellow (input pulses); red (wire fault)
Output status indication LED	green (lights when the relay is energised / the transistor is closed)
Function display LED	LCD display; 7/14-segment
Electrical connection	
Connection	dual-chamber terminals 2 x 2.5 mm <sup>2</sup> (2 x AWG 14)
<b>Wiring</b>	
1: DC Supply voltage (L-)	
2: DC Supply voltage (L+)	
3: supply transistor outputs (L+)	
4: error output pnp	
5: 8.2 V DC Sensor supply (L-)	
6: 8.2 V DC Sensor supply (L+)	
7: AC/DC Supply voltage	
8: AC/DC Supply voltage	
9: n.c.	
10: stepping output sensor signal	
11: n.c.	
12: n.c.	
13: Relay 1 (common)	
14: Relay 1 (normally open)	
15: Relay 1 (normally closed)	
16: transistor output 1 pnp	
17: Reset 1 pnp	
18: Reset 2 pnp	
19: Relay 2 (common)	
20: Relay 2 (normally open)	
21: Relay 2 (normally closed)	
22: analog output (+)	
23: analog output (-)	
24: transistor output 2 pnp	
Remarks	
Remarks	overvoltage category II; degree of soiling 2
Pack quantity [piece]	1

ifm efector, inc. • 1100 Atwater Drive • Malvern • PA 19355 — We reserve the right to make technical alterations without prior notice. — US — DD2104 — 28.08.2012

no longer available - archive entry replaced by: DD2603

Article available until 31 March 2014