

no longer available - archive entry replaced by: DD2505
 Article available until 31 March 2014

ecomat200[®]
 DD2005



MONITOR/FR-2 /110-240VAC/DC

Evaluation systems, power supplies

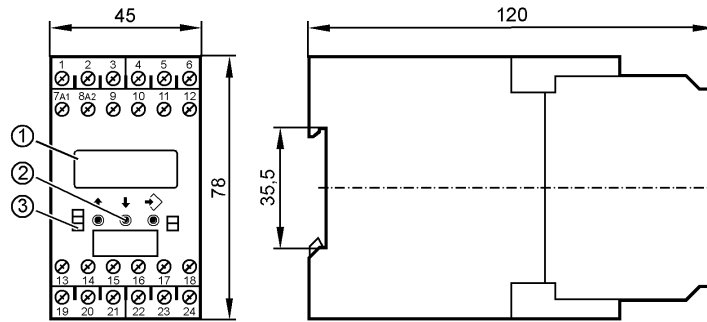

- 1: LCD display; 7/14-segment
- 2: Programming buttons
- 3: LEDs



Product characteristics

MONITOR	
FR-2	
Housing for DIN rail mounting	
2 relay outputs	
2 transistor outputs	
programmable	
Test function without external frequency	
Key function	
Application	
Application	double pulse evaluation system with μ processor for frequency, rotational speed, speed and machine cycles
Switching function	1 switch point each for monitoring overspeed/underspeed and acceptable range
Electrical data	
Nominal voltage [V]	110...240 AC (50...60 Hz) / 27 DC (typ. 24 DC)
Voltage tolerance [%]	-20...+10
Power consumption [VA]	5 (3 W)
Inputs	
Inputs	<p>pnp/npn; NAMUR (24 V)</p> <p>auxiliary supply: typ. 24 V DC / 15 mA; short-circuit protected</p> <p>threshold pnp: > 12 V on; < 5 V off</p> <p>threshold npn: > 15 V off; < 8 V on</p> <p>input frequency (max): 5 kHz (corresponds to min. pulse length / space 0.1 ms)</p>
Outputs	
Relay	
Contact rating	6 A (250 V AC); B300, R300
Transistor	
Transistor outputs	<p>pnp; external supply</p> <p>switching voltage/current: 24 V DC / max. 15 mA; short-circuit protected</p>
Measuring / setting range	
Setting range [pulses/min.]	1...60000 (0.1...1000 Hz)
Accuracy / deviations	
Measuring error [% of the final value]	< 1
Environment	

DD2005 - MONITOR - eclass: 27279213 / 27-27-92-13

Ambient temperature	[°C]	-20...60
Storage temperature	[°C]	-25...80
Max. relative air humidity	[%]	75 (35°C)
Protection housing / terminals		IP 50 / IP 20
Tests / approvals		
EMC	EN 61010	: 2001
	EMC 89/336/EEC	
	EN 61000-6-3	: 2007
	EN 61000-6-2	: 2005
Mechanical data		
Housing materials		plastics
Weight	[kg]	0.348
Displays / operating elements		
Input pulses	LED	yellow
Output status indication	LED	green (lights when the relay is energised / the transistor is closed)
Function display	LED	LCD display; 7/14-segment
Electrical connection		
Connection		dual-chamber terminals 2 x 2.5 mm ² (2 x AWG 14)
Wiring		
1: DC Supply voltage (L-)		
2: DC Supply voltage (L+)		
3: supply transistor outputs (L+)		
4: sensor signal 1 pnp		
5: DC Sensor supply (L+)		
6: DC Sensor supply (L-)		
7: AC Supply voltage (L1)		
8: AC Supply voltage (N)		
9: n.c.		
10: sensor signal 1 npn		
11: sensor signal 2 pnp		
12: sensor signal 2 npn		
13: Relay 1 (common)		
14: Relay 1 (normally open)		
15: Relay 1 (normally closed)		
16: transistor output 1 pnp		
17: Reset 1 pnp		
18: Reset 2 pnp		
19: Relay 2 (common)		
20: Relay 2 (normally open)		
21: Relay 2 (normally closed)		
22: n.c.		
23: n.c.		
24: transistor output 2 pnp		
Remarks		
Remarks		overvoltage category II; degree of soiling 2
Pack quantity	[piece]	1

ifm efector, inc. • 1100 Atwater Drive • Malvern • PA 19355 — We reserve the right to make technical alterations without prior notice. — US — DD2005 — 06.12.2012

no longer available - archive entryreplaced by: DD2505

Article available until 31 March 2014