

**AC4002**

Flat cable 1 meter EPDM bk

AS-Interface bus system

**no longer available - archive entry**

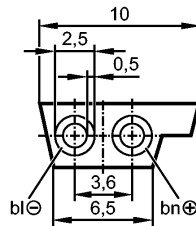

**Product characteristics**

AS-i flat cable  
 for use in insulation displacement connector technology for FC lower parts and compact modules  
 Reverse polarity protection due to special shape  
 100 m

**Electrical data**

Electrical design	external 24 V power supply
Operating voltage [V]	24 DC

**Environment**

Ambient temperature [°C]	-40...85
Protection	IP 67

**Mechanical data**

Weight [kg]	0.078
-------------	-------

**Electrical connection**

Connection	2 x 1.5 mm <sup>2</sup>
Material	EPDM
Sheath color	black

**Remarks**

Pack quantity [piece]	1
-----------------------	---

**Other data**

Previous article no.	Material / Colour	Application	Length [m]	Length [m]	Length [m]	Length [m]
			100	50	500	1000
AC4000	EDPM / ye		E74000	E74002	E74003	—
AC4002	EDPM / bk		E74010	E74012	E74013	
AC4001	PUR / ye		E74100	—	—	E74104
AC4006	PUR / bk		E74110	—	—	E74114
AC4003	TPE / ye		E74200	—	—	—
AC4004	TPE / bk		E74210	—	—	—
AC4005	TPR / rd		E74220	—	—	—
AC4007	TPE-PVC / ye	Food industry	E74300	—	—	—
AC4008	TPE-PVC / bk	Food industry	E74310	—	—	—

**no longer available - archive entry**