

TARGET PRESENT
RED LED INDICATION

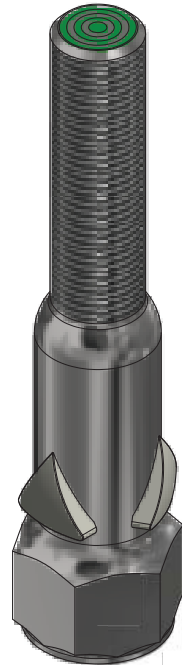

NO TARGET PRESENT
NO LED INDICATION



MODEL NUMBER

7LR-1356E-A2

PRODUCT LINE

GO™ Switch 70 Series LED

SPECIFICATIONS

Model	7L- Red LED
Contact Form	SPDT
Sensing Range	0.100" End Sensing
Outlet Position	Bottom of Enclosure
Enclosure Material	316L Stainless Steel
Area Classification	cULus Class I Div 2
Wiring Option	PVC Lead Wires - 3ft
Custom Field	

WIRING DIAGRAM

PVC/PTFE LEADS - 4 WIRE
SPDT

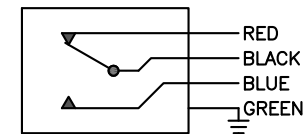

NAMEPLATE

Model #:
Serial #:
Class I, Division 2, Groups A,B,C,D; Type 4X
Class II, Division 2, Groups F,G; Class III
-40°C ≤ Ta ≤ 60°C
120VAC/0.25A; 24VDC/0.25A
Conduit: 1/2 NPT - Lead Seal Required



www.electrosupply.com
sales@electrosupply.com
1-800-663-6576