

Two-Piece Magnetic Actuated Reed Switches

- DC rated reed contacts
- Short-axis slide-by, head-on or ferromagnetic vane operation modes
- Compatible with solid state logic level inputs
- Internal dry reed switch
- Hermetically sealed contacts
- Heavy duty aluminum housings
- 1/2" NPT conduit outlet

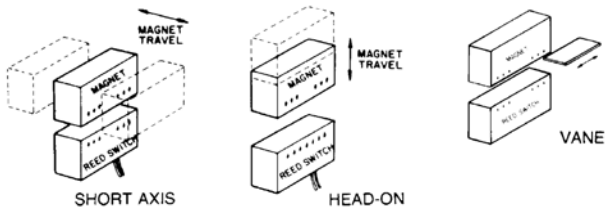

Modes of Operation



Magnet Actuator (Must be ordered separately)

Model No. 21FR1-B

Temperature Effects

Temperature must be taken into consideration when using magnetically operated switches. The sensing ranges given on the following pages are for head-on operations at room temperature (75° F). Sub-zero temperatures can cause permanently reduced sensitivity. Use the following table as a guide for potential sensitivity loss.

Model	Maximum Possible Sensitivity Loss
20FR1-6B	2.03 mm
20FR3-6B	1.52 mm

Wiring Diagrams

2-Wire DC



Cable Connection

Normally open

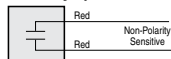

Specifications	2-Wire Contact
SENSING RANGE	61 mm
SHIELDED	No
MODEL NUMBER(S)	20FR1-6B ⚡
OUTPUT	SPST relay, N.O.
POWER RATING	400 VDC, 1 A, 15 W
MECHANICAL LIFE	1 x 10 ⁷ operations
LED(s)	No
RELEASE POINT	76.2 mm
HYSTERESIS	15.2 mm
STANDARDS	NEMA ICS 5-2000
PROTECTION (IEC)	IP68
AMBIENT TEMPERATURE	-20 °F to +200 °F
HOUSING MATERIAL	Aluminum
<i>SENSING FACE</i>	Aluminum
APPROVALS	CE
ELECTRICAL CONNECTION	 1.83-meter cable, PVC covered, 2-conductor, #16 AWG

- ⚡ Stocked item
- Typical delivery 4 weeks or less
Consult factory for all other models

Dimensions (mm)

20FR Sensor

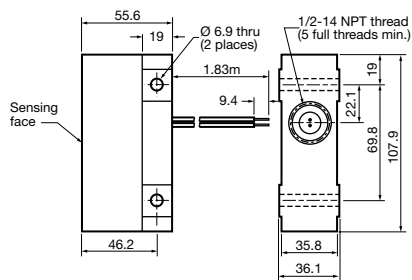

Mounting Bracket

(included with each 20FR sensor)

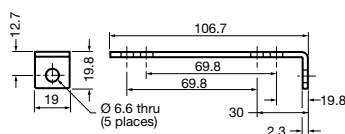

21FR1-B Magnet Actuator

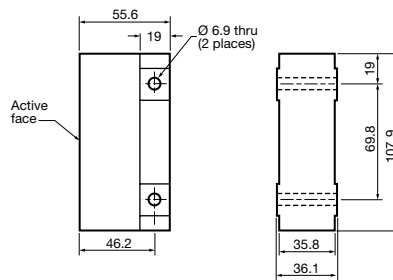

Mounting Bracket

(included with each 21FR1-B magnet)

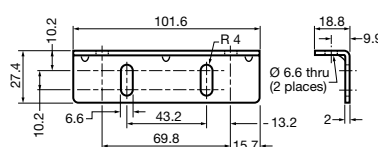

Subject to modifications without notice

Pepperl+Fuchs Group
www.pepperl-fuchs.com

USA: +1 330 486 0001
fa-info@us.pepperl-fuchs.com

Germany: +49 621 776 0
fa-info@de.pepperl-fuchs.com

Copyright Pepperl+Fuchs
Singapore: +65 6779 9091
fa-info@sg.pepperl-fuchs.com

PF PEPPERL+FUCHS
SENSING YOUR NEEDS